

Tilda®

# MERRY LITTLE CHRISTMAS

Winter Bird Pillow  
Petrol





# Winter Birds Pillow

(Petrol colourway)

A large, comfy pillow is ideal for snuggling up to during the winter and is also the perfect companion to the Winter Bird quilt. This version of the pillow uses a putty white Chambray fabric for the background contrasting with a petrol print, which is reminiscent of winter evergreens. The petrol colour works beautifully with the reds and greens of the Merry Little Christmas fabric collection and its blenders. There is a second pillow in this design using a warm burgundy and putty white as the backgrounds. For the instructions for the other pillow, plus the two gorgeous Winter Bird quilts – see [tildasworld.com](http://tildasworld.com).

Difficulty rating \*\*

## Materials

- Fabric 1: about 5in (13cm) square – Holly red (100621)
- Fabric 2: about 9in (23cm) square – Carol burgundy (100622)
- Fabric 3: about 5in (13cm) square – Mistletoe red (100623)
- Fabric 4: about 5in (13cm) square – Holly moss (100631)
- Fabric 5: about 5in (13cm) square – Carol moss (100632)
- Fabric 6: about 5in (13cm) square – Mistletoe pistachio (100633)
- Fabric 7: about 5in (13cm) square – Joy pine (100634)
- Fabric 8: about 5in (13cm) square – Paper Scenes artichoke (100635)
- Fabric 9: about 9in (23cm) square – Mistletoe cream (100639)
- Fabric 10: about 5in (13cm) square – Eve red (110138)
- Fabric 11: about 5in (13cm) square – Noel red (110139)
- Fabric 12: ½yd (50cm) – Eve petrol (110142) (background)
- Fabric 13: about 9in (23cm) square – Joy red (100624)
- Fabric 14: about 5in (13cm) square – Noel mist (110143)
- Fabric 15: about 9in (23cm) square – Eve pine (110144)
- Fabric 16: about 5in (13cm) square – Noel moss (110145)
- Fabric 17: about 9in (23cm) square – Eve sage (110146)
- Fabric 18: about 9in (23cm) square – Joy cream (100638)
- Fabric 19: ¾yd (40cm) – Chambray putty white (160043) (background)
- Fabric 20: about 5in (13cm) square – Tiny Dot red (160081)
- Fabric 21: about 5in (13cm) square – Stripe green (160082)
- Fabric 22: about 5in (13cm) square – Polka Dot red (160085)
- Fabric 23: about 5in (13cm) square – Gingham red (160087)
- Wadding (batting): 33in x 23in (84cm x 30.5cm)
- Lining fabric (optional): 33in x 23in (84cm x 30.5cm)
- Backing fabric: ¾yd (75cm) – Carol duck egg (100627)
- Binding fabric: ¼yd (25cm) – Eve sage (110146)
- Piecing and quilting threads
- Black stranded cotton (floss) for French knot eyes on the birds
- Quilter's ruler, rotary cutter and mat
- Five buttons for fastening (optional) – Merry Little Christmas buttons 16mm (400072)
- Pillow pad to fit cover

## Fabric Notes

Fabric 11 and Fabric 23 only need one 1½in (3.8cm) circle for appliqué, so scraps of these two fabrics would be sufficient.

## Finished Size

30¼in x 20½in (76.8cm x 52cm)

## General Notes

- Fabric quantities are based on a usable width of 42in (107cm), unless otherwise stated.
- Measurements are in imperial inches with metric conversions in brackets – use only *one* system throughout (preferably inches). Width measurements are generally given first.
- Press fabric before cutting and trim as needed to square up the fabric pattern/weave, using a quilting ruler to cut the top raw edge at 90 degrees to the selvages.
- Use ¼in (6mm) seams unless otherwise instructed.
- Read all the instructions through before you start.
- Always make one complete block as a test before going on to make the remaining blocks.
- Abbreviations: RS = right side; WS = wrong side; HST = half-square triangle.
- Check that any patterns being used are printed at full size (100%).

## Pillow Layout

1 The pillow layout consists of three columns made up of Bird blocks and Leaf blocks. There are three Bird blocks, in different colourways and two different Leaf blocks in different colourways. The Leaf blocks have ‘berries’ made with turned-edge appliqué and a circle pattern is included for this, if required. There is an unpieced border at the sides of the pillow and a border of pieced squares at the top and bottom. Refer to **Fig A** for the fabrics used and **Fig B** for the pillow layout.

**Fig A** Fabric swatches (Winter Birds Pillow – petrol)

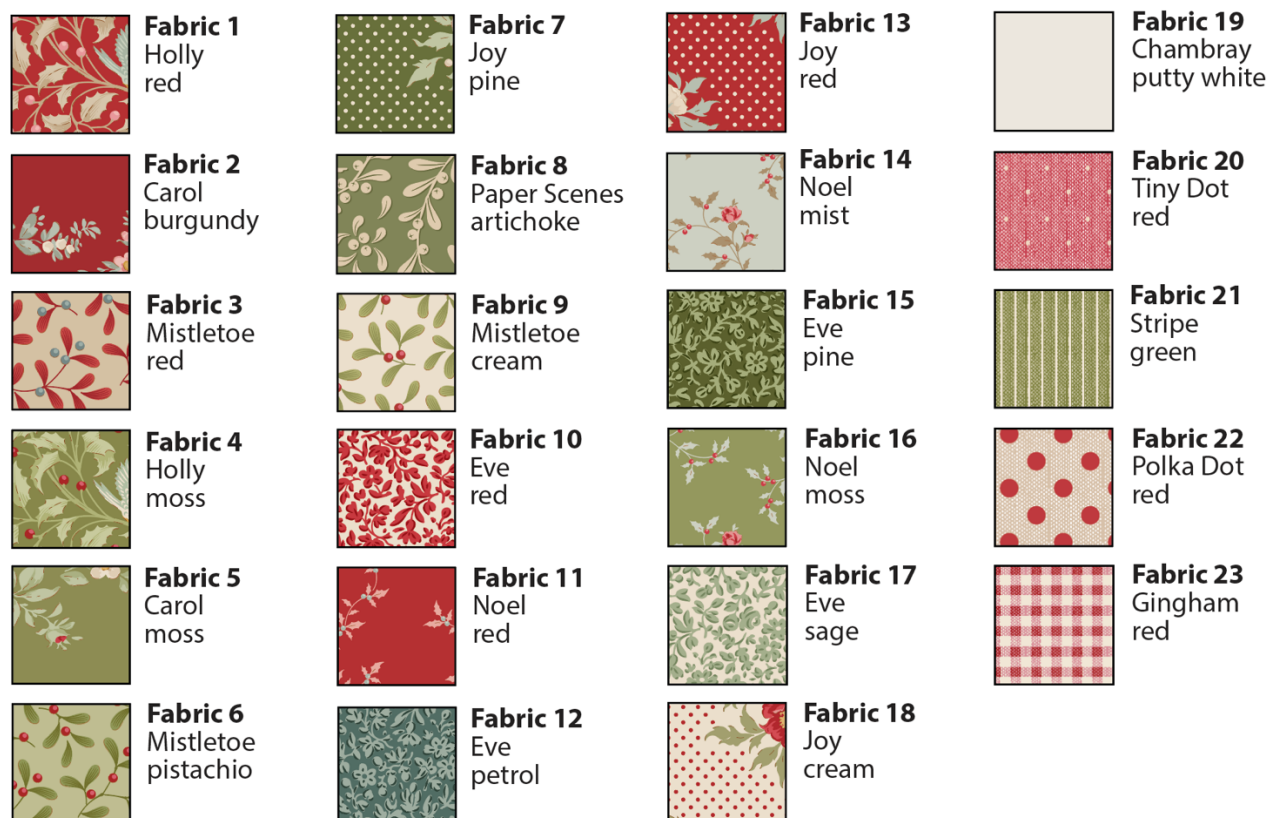

**Fig B** Pillow layout

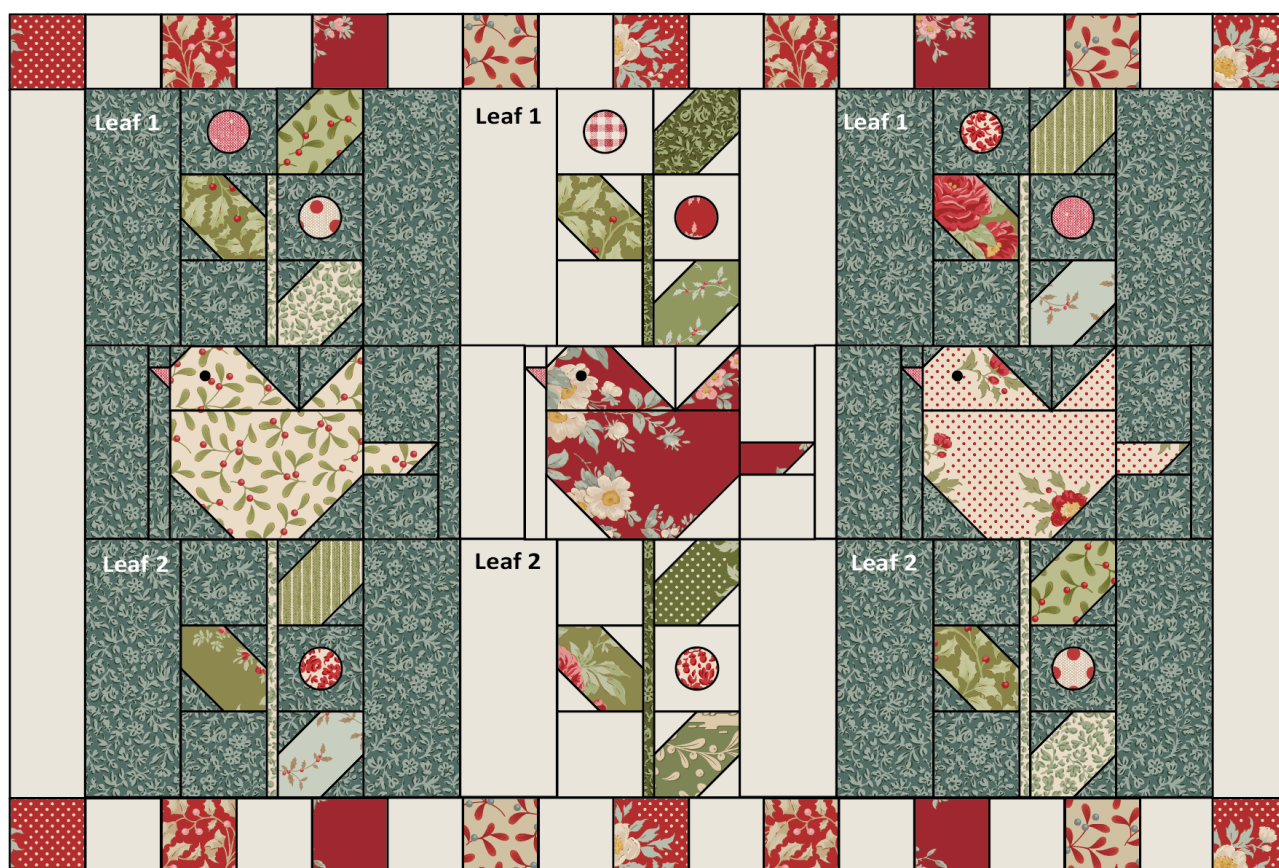

## Cutting Out

**2** The two Leaf blocks (Leaf 1 and Leaf 2) have slightly different layouts so follow the diagrams in **Fig C** carefully to cut the sizes given. Note that there are four Leaf blocks with dark backgrounds and two Leaf blocks with light backgrounds. For the blocks follow the fabric colours given in **Fig D**.

For the nine appliqué circles, cut the following 1½in (3.8cm) diameter circles (use the pattern provided if you wish). This size includes a ¼in (6mm) seam allowance.

- Fabric 10 – cut three circles.
- Fabric 11 – cut one circle.
- Fabric 20 – cut two circles.
- Fabric 22 – cut two circles.
- Fabric 23 – cut one circle.

**3** For the Bird blocks, use the cut sizes given in **Fig C** and follow the fabric colours given in **Fig D**. For each bird you will only need the bird fabric colour, the beak colour and the background colour. Note that there are two Bird blocks with dark backgrounds and one Bird block with a light background.

**4** For the side borders and top and bottom pieced border, cut the following.

- From Fabric 19 cut two strips 2¼in x 17in (5.7cm x 43.2cm) for the side borders.
- From Fabric 19 cut sixteen 2¼in (5.7cm) squares for the top and bottom border.
- From each of Fabrics 1, 2 and 3 cut four 2¼in (5.7cm) squares for the top and bottom border.
- From Fabric 13 cut six 2¼in (5.7cm) squares for the top and bottom border.



**5** From the backing fabric cut two pieces 31in x 13½in (78.8cm x 34.3cm).

**6** Cut the binding fabric into three 2½in (6.4cm) x width of fabric strips. Sew together end to end and press seams open. Press the binding in half along the length, wrong sides together.

### Fig C Cut measurements for the blocks

Sizes include ¼in (6mm) seam allowances

All pieces to be cut initially as squares or rectangles

#### Leaf 1

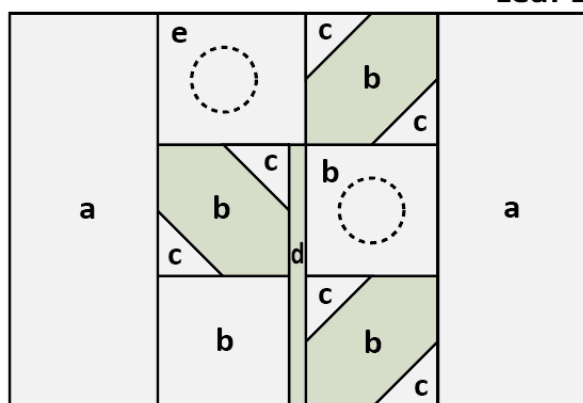

**a** 2¾in x 6½in (7cm x 16.5cm)

**b** 2½in (6.4cm) square

**c** 1½in (3.8cm) square

**d** ¾in x 4½in (2cm x 11.4cm)

**e** 2¾in x 2½in (7cm x 6.4cm)

○ **Berries:** Cut fabric circles 1½in (3.8cm) in diameter (for 1in/2.5cm finished appliqué circles – see instructions)

#### Leaf 2

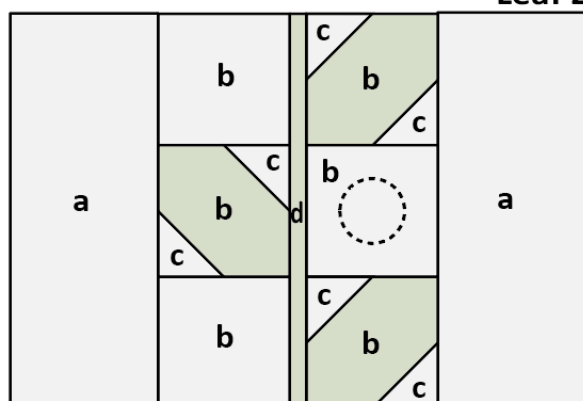

**a** 2¾in x 6½in (7cm x 16.5cm)

**b** 2½in (6.4cm) square

**c** 1½in (3.8cm) square

**d** ¾in x 6½in (2cm x 16.5cm)

○ **Berry:** Cut fabric circle 1½in (3.8cm) in diameter (for 1in/2.5cm finished appliqué circle – see instructions)

#### Bird

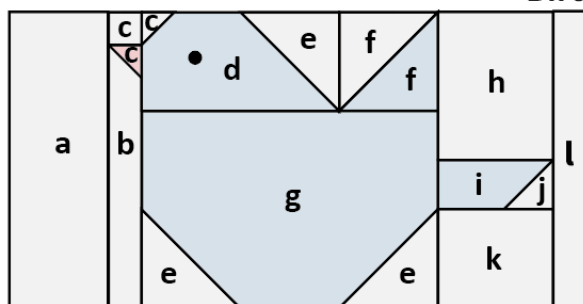

**a** 2in x 5in (5.1cm x 12.7cm)

**b** 1in x 4½in (2.5cm x 11.4cm)

**c** 1in (2.5cm) square

**d** 3½in x 2in (9cm x 5.1cm)

**e** 2in (5.1cm) square

**f** 2⅜in (6cm) square for 2in (5.1cm) unfinished HSTs

**g** 5in x 3½in (12.7cm x 9cm)

**h** 2¼in x 2¾in (5.7cm x 7cm)

**i** 2¼in x 1¼in (5.7cm x 3.2cm)

**j** 1¼in (3.2cm) square

**k** 2¼in x 2in (5.7cm x 5.1cm)

**l** 1in x 5in (2.5cm x 12.7cm)

**Eye** Work as a French knot – see instructions

## Fig D Pillow fabric positions

Bold numbers in circles indicate the fabrics used (see Fig A)

The backgrounds are Fabric 12 and Fabric 19. Bird beaks are Fabric 20

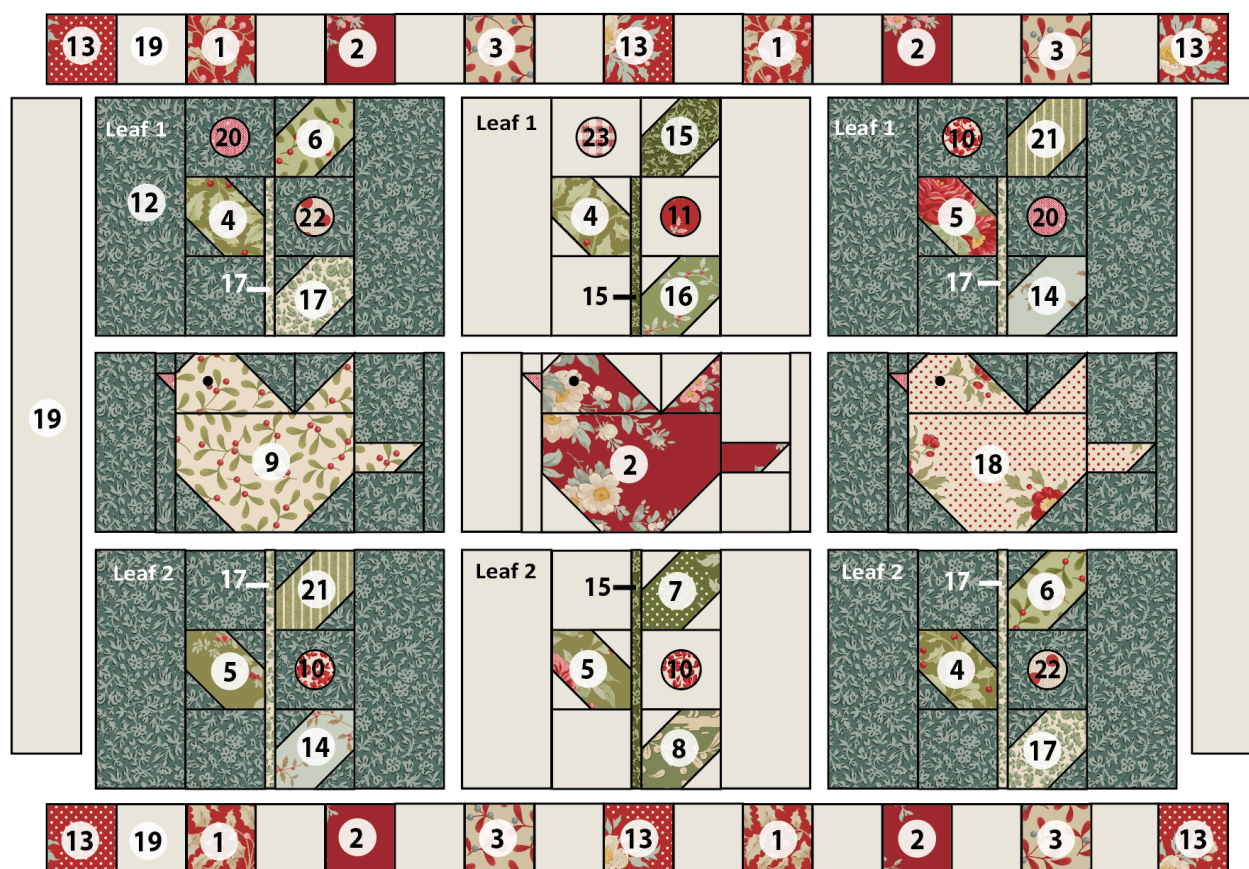

## Making the Leaf Blocks

**7** The Leaf blocks are made in a similar way, except that Leaf 1 has a shorter stem. The leaves themselves are made up of a unit that has a print fabric square with two corner triangles, created using the technique shown below in **Fig E**. Follow **Fig D** (above) carefully to see the correct fabrics to use and on which corners to place the triangles.

**8** To make the corner units, choose the correct background fabric square and the two smaller print or Chambray squares. Follow the sequence shown in **Fig E**, placing the square of print fabric right side (RS) up. Take the two smaller squares and pencil mark a diagonal line on the wrong side of each square. Position the squares right sides together with the print rectangle, in the correct positions for that particular unit and with the marked lines in the directions shown in the diagram. Pin in place and then sew along each marked line. Trim off excess fabric  $\frac{1}{4}$ in (6mm) outside the sewn lines and press each triangle outwards. Check the size of the unit, which needs to be  $2\frac{1}{2}$ in (6.4cm) square (unfinished) (for all of the Leaf blocks).

## Fig E Making a corner triangle unit

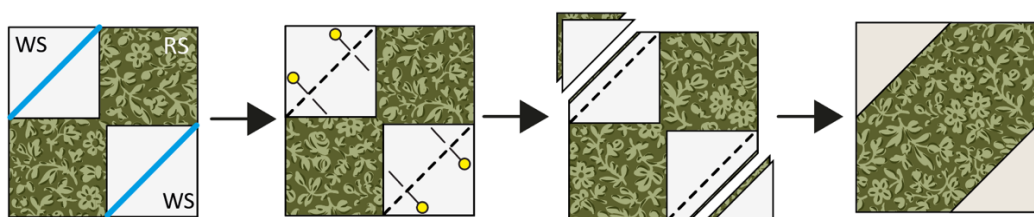



**9** When all of the individual leaf units have been made for a block, they can be sewn together with the other pieces needed for the block. Follow the sequence shown in **Fig F** to assemble a Leaf 1 block. Press each seam as you sew it, pressing it open or to one side. The block should be  $9\frac{1}{4}\text{in} \times 6\frac{1}{2}\text{in}$  (23.5cm x 16.5cm) (unfinished). The appliqué circles for the berries can be added now or when all of the Leaf blocks are made (the appliqué is described in Step 14).

The assembly for a Leaf 2 block is slightly different, so follow the sequence shown in **Fig G**. Once sewn this block should be the same size as the other Leaf block.

**10** Make all six of the Leaf blocks needed, following **Fig D** carefully for the different layouts and fabrics used.

**Fig F** Making a Leaf 1 block

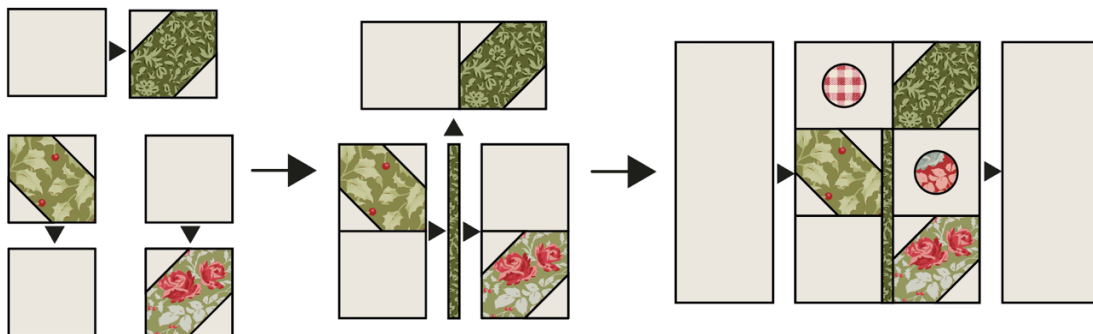

**Fig G** Making a Leaf 2 block

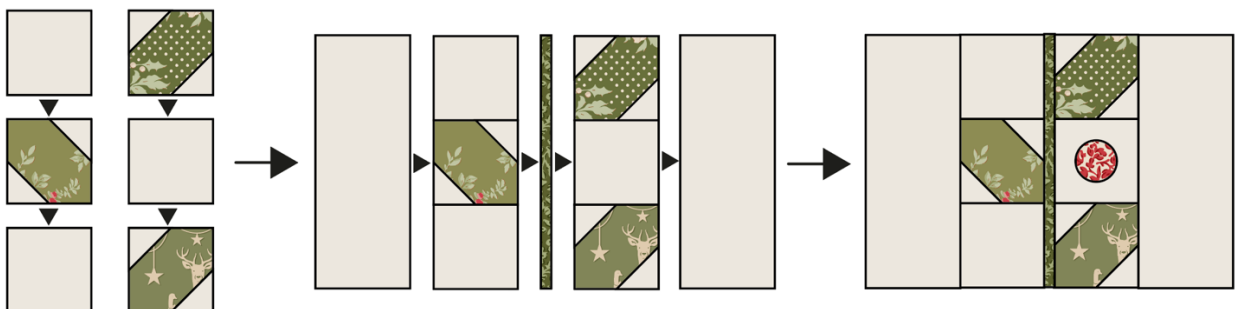

## Making the Bird Blocks

**11** The Bird blocks are all made the same way, two with a dark background and one with a light background. The bird fabrics are all different, so follow **Fig D** carefully. The birds use a half-square triangle (HST) unit for the tail. The method shown in **Fig H 1** makes two units at the same time, so one unit will be spare.

Take two different squares and on the wrong side of the lighter square, pencil mark the diagonal line. Place the two squares right sides (RS) together and sew  $\frac{1}{4}\text{in}$  (6mm) away from the marked line on both sides. Cut the units apart along the marked line and press the units. (normally towards the darker fabric). Check each HST is 2in (5.1cm) square (unfinished).

**12** The Bird blocks also use corner triangle units in a similar way to the Leaf blocks. To make these, use the technique shown previously in **Fig E**. Follow **Fig H 2**, **H 3** and **H 4** below to see where these triangles occur, paying close attention to selecting the correct sizes and fabrics and adding the corners in the correct places. The bird with the light background is shown but the method is the same for the dark birds.

**Fig H** Making the units for a Bird block

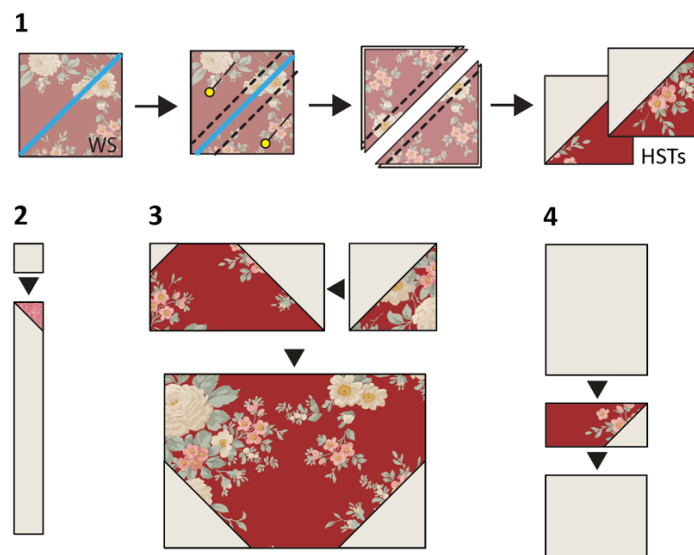

**13** When all of the individual units have been made for a Bird block, they can be sewn together with the other pieces needed for the block. The assembly process is shown in **Fig I**. Follow the stages shown, pressing each seam as you sew, pressing them open or to one side. The Bird block should be  $9\frac{1}{4}\text{in} \times 5\text{in}$  (23.5cm x 12.7cm) (unfinished). You can add the French knot eye now or later (see Step 15). Make the two dark birds in the same way.

**Fig I** Assembling a Bird block

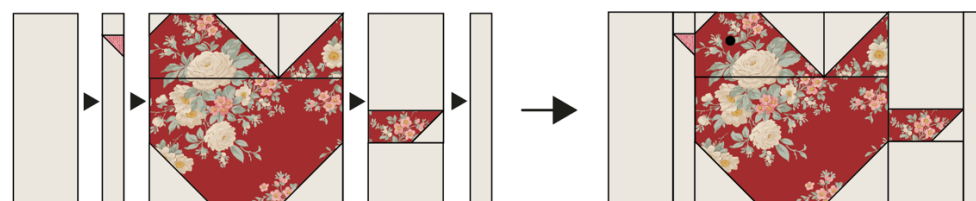

## Sewing the Appliqué and the Eyes

**14** Make the appliqué berries for the Leaf blocks using a card and gathering thread technique (turned-edge appliqué). Cut a 1in (2.5cm) diameter circle from a piece of stiff card. Take the  $1\frac{1}{2}\text{in}$  (3.8cm) diameter circle of fabric cut earlier and place the 1in (2.5cm) diameter card circle in the centre of the fabric on the wrong side. Mark the card circle (**Fig J**). Remove the card for the moment. Using a strong or doubled thread, hand sew a gathering stitch all around this marked inner circle, slightly outside of the marked line. Leave tails of thread. Put the card circle back in place and pull on the gathering thread to gather it up over the edge of the card. Tie off the thread. Press well and then remove the card. Press again from the right side using a little spray starch. Make nine circles for the Leaf blocks. Using a matching hand sewing thread and small slip stitches, sew the circles in place on the blocks and press.

**Fig J** Sewing the appliqué

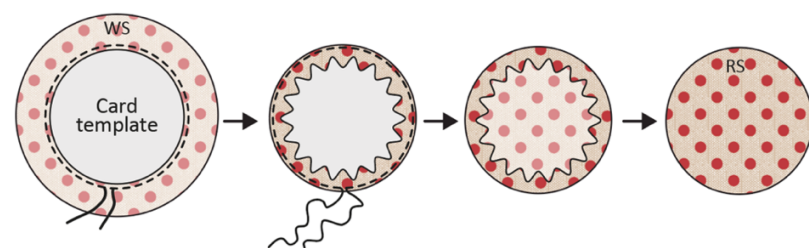



**15** Work the eyes on the birds using black stranded cotton (floss) with six strands wrapped twice around the needle. (You may have already sewn these.)

## Assembling the Patchwork

**16** Make the two pieced squares borders for the top and bottom of the pillow as shown in **Fig K** (following **Fig D** for the fabric order of the squares).

**Fig K** Sewing the pieced squares borders

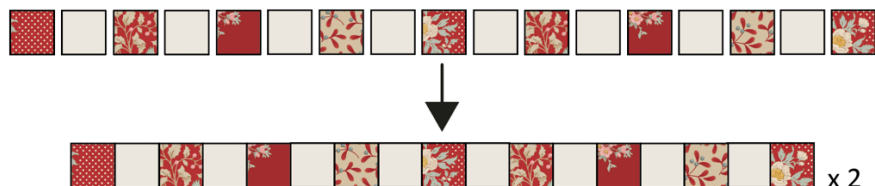

**17** The pillow can now be assembled following **Fig L**. Sew the blocks together first, pressing the seams open or to one side. Add the side borders, pressing the seams towards the borders, and then add the pieced squares borders at the top and bottom of the pillow and press.

**Fig L** Assembling the patchwork

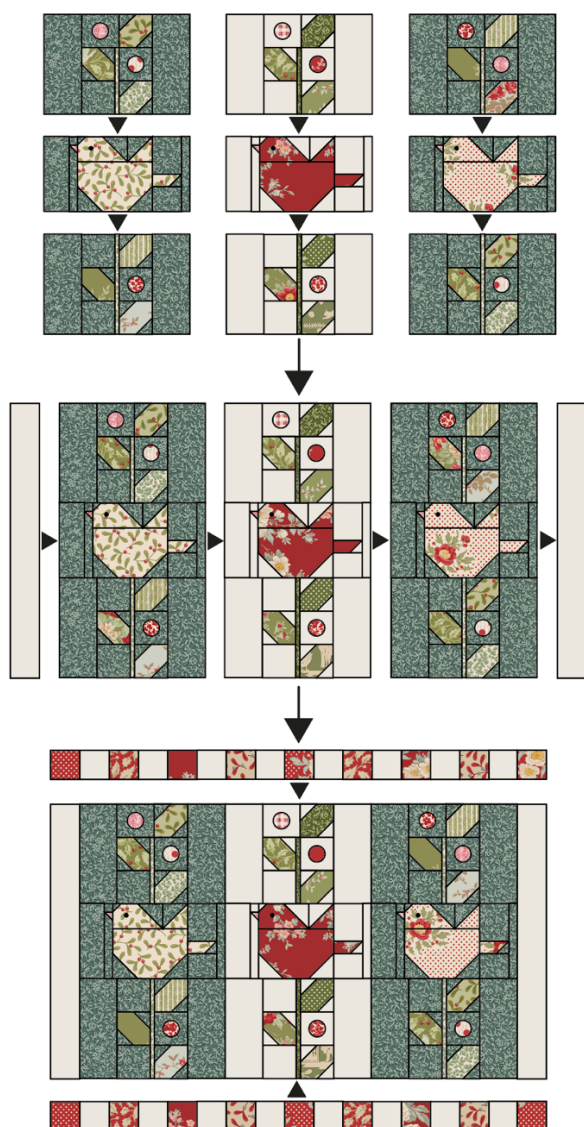

## Quilting and Finishing

**18** Make a quilt sandwich of the patchwork, wadding (batting) and lining fabric (if using). Quilt as desired. Trim off excess wadding and lining fabric to match the patchwork size.

**19** To make up the pillow cover, take the two pieces of fabric for the cushion back and on one long edge of each piece, create a hem by turning the edge over by 1 in (2.5cm), twice. Sew the seams with matching thread and press (**Fig M**). The diagram is shown in greys, so you can use the Tilda fabric and buttons suggested in the Materials list, or those of your choice.

**20** For the fastening, using your sewing machine, create five equally spaced buttonholes within the hem of one of the pieces. Sew five buttons onto the other piece, matching their positions to the buttonholes. Note: Instead of making buttonholes, you could use a hook and loop fastening, such as Velcro, to fasten the cover and sew on the buttons as a decorative feature.

**21** The pillow has a bound edge, so the pieces are assembled with right sides out, as follows. On the backing, fasten the buttons into the buttonholes and place the whole piece right side down. Place the quilted patchwork on top, right side up. Make sure the outer edges of all pieces are aligned. Pin or tack (baste) the layers together and then bind as normal. As you sew the binding in place it will fix the other layers together. Press the cover and insert a pillow pad to finish.

**Fig M** Making up the cover

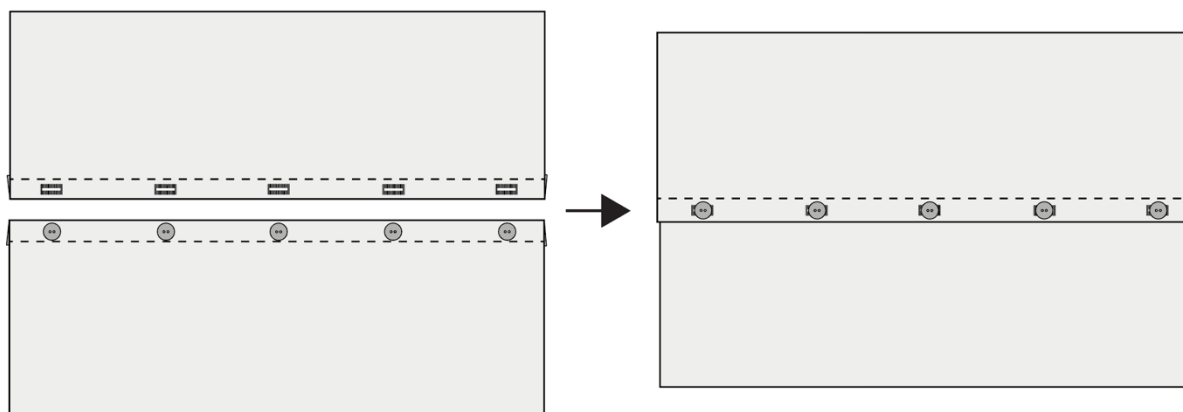



## Winter Birds

### Circle pattern for appliqué

Berries are 1in (2.5cm)  
finished diameter

