



Tilda®

MERRY LITTLE
CHRISTMAS

Heart Garland Pillows
Two Colors



Heart Garland Pillow

(Plaid colourway)

This charming pillow is simply a section of patchwork framed by a border, so it is easy to make. It will add a welcoming touch to your home during the winter season and can also be used as a companion to the Dear Santa quilts. The Plaid fabric in stone used for the background adds a lovely rustic touch and works well with the reds and greens from the Merry Little Christmas fabric collection and its blenders. There is a second version of the pillow where the seasonal colours are paired with a restful putty white Chambray. For the instructions for the other pillow, plus the two Dear Santa quilts – see tildasworld.com.

Difficulty rating *

Materials

- Fabric 1: ½yd (50cm) – Plaid stone (160079) (background)
- Fabric 2: about 5in (13cm) square – Holly red (100621)
- Fabric 3: about 5in (13cm) square – Carol burgundy (100622)
- Fabric 4: about 5in (13cm) square – Joy red (100624)
- Fabric 5: about 5in (13cm) square – Noel moss (110145)
- Fabric 6: about 5in (13cm) square – Holly moss (100631)
- Fabric 7: about 5in (13cm) square – Eve pine (110144)
- Fabric 8: about 5in (13cm) square – Joy pine (100634)
- Fabric 9: about 5in (13cm) square – Mistletoe pistachio (100633)
- Fabric 10: about 5in (13cm) square – Paper Scenes artichoke (100635)
- Wadding (batting): 30in x 17in (76cm x 43cm)
- Lining fabric (optional): 30in x 17in (76cm x 43cm)
- Backing fabric: ⅝yd (60cm) – Holly clay (100636)
- Binding fabric: ¼yd (25cm) – Polka Dot red (160085)
- Piecing and quilting threads
- Quilter's ruler, rotary cutter and mat
- Five buttons for fastening (optional) – Merry Little Christmas buttons 16mm (400072)
- Pillow pad to fit cover

Fabric Notes

All of the fabrics, apart from the background, only need small pieces, so you may have fabrics left over from your other Merry Little Christmas projects.

Finished Size

27½in x 15in (70cm x 38cm)

General Notes

- Fabric quantities are based on a usable width of 42in (107cm), unless otherwise stated.
- Measurements are in imperial inches with metric conversions in brackets – use only *one* system throughout (preferably inches). Width measurements are generally given first.
- Press fabric before cutting and trim as needed to square up the fabric pattern/weave, using a quilting ruler to cut the top raw edge at 90 degrees to the selvages.
- Use ¼in (6mm) seams unless otherwise instructed.
- Read all the instructions through before you start.
- Always make one complete block as a test before going on to make the remaining blocks.

- Abbreviations: RS = right side; WS = wrong side; HST = half-square triangle.

Pillow Layout

1 The pillow layout consists of a strip of patchwork made up of three heart units and two leaf units and the patchwork is framed by a border on all sides. Refer to **Fig A** for the fabrics used and **Fig B** for the pillow layout.

Fig A Fabric swatches (Heart Garland Pillow – plaid)

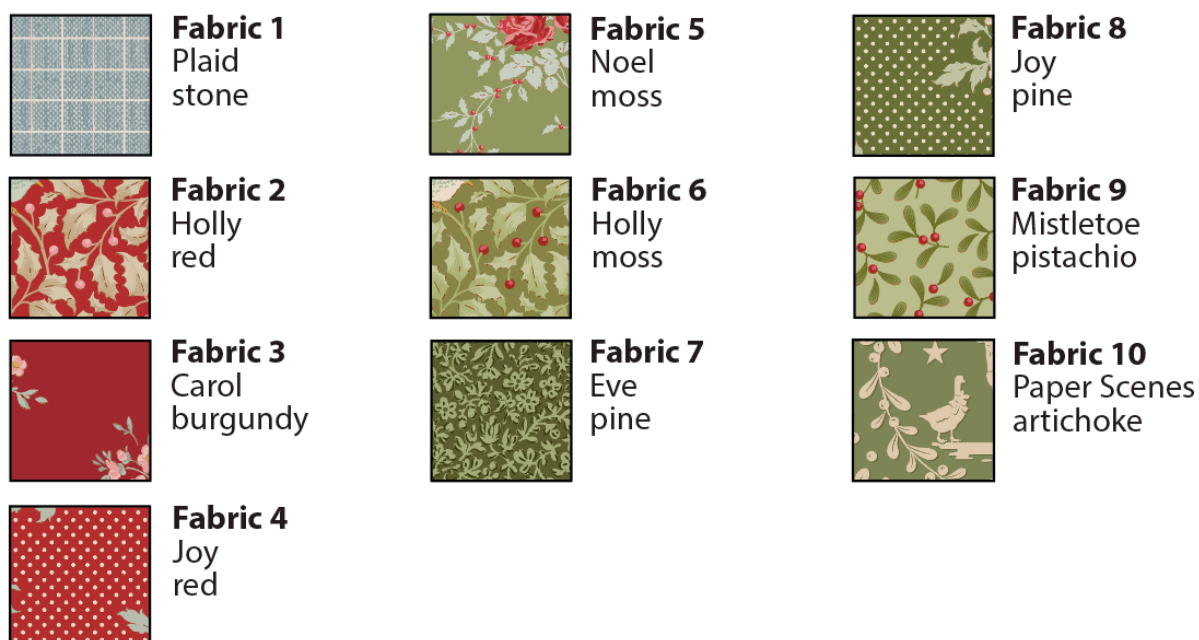
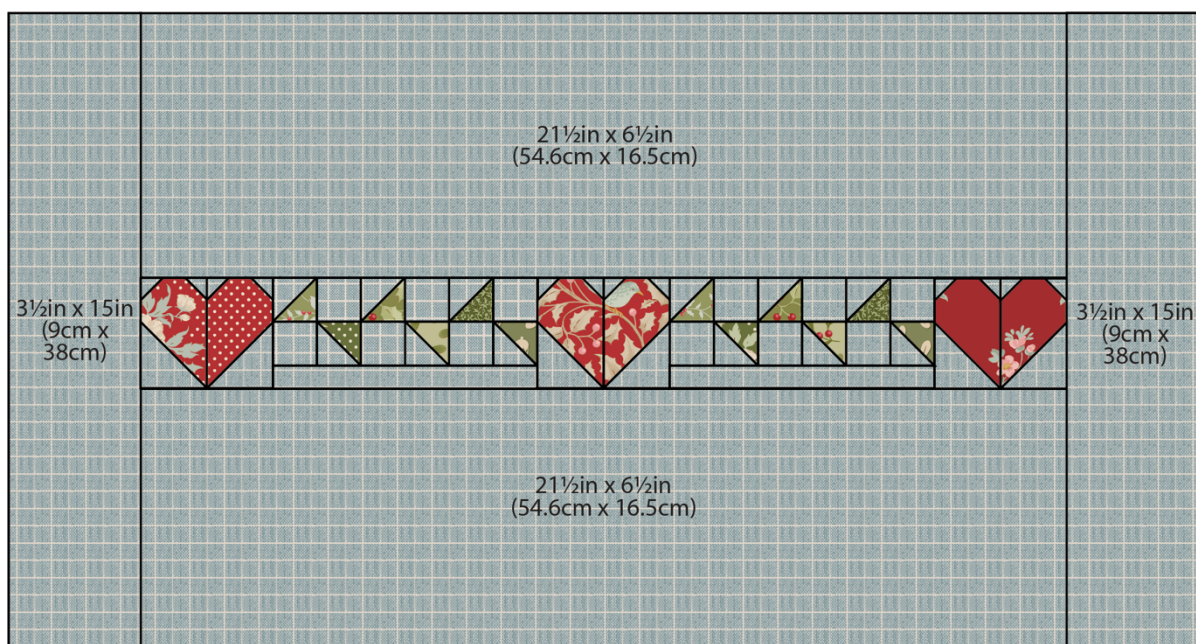

Fig B Pillow layout



Cutting Out

2 From Fabric 1, cut the border strips first, as follows and shown in **Fig B**.

- Two strips 21 1/2 in x 6 1/2 in (54.6 cm x 16.5 cm) for the top and bottom borders.
- Two strips 3 1/2 in x 15 in (9 cm x 38 cm) for the side borders.

3 For the patchwork, follow **Fig C** to cut the sizes given and **Fig D** for the fabric positions. You will need to cut pieces for three heart units and two leaf units.

4 From the backing fabric cut two pieces 28in x 11in (71cm x 28cm).

5 Cut the binding fabric into three 2½in (6.4cm) x width of fabric strips. Sew together end to end and press seams open. Press the binding in half along the length, wrong sides together.

Fig C Cut measurements for the patchwork

Sizes include ¼in (6mm) seam allowances

All pieces to be cut initially as squares or rectangles

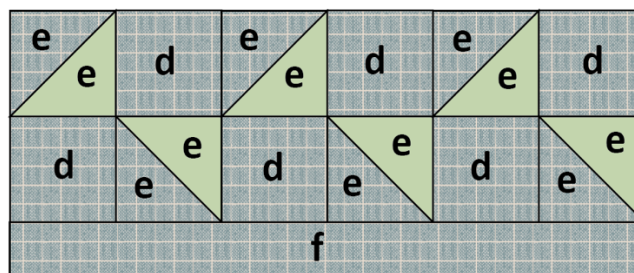
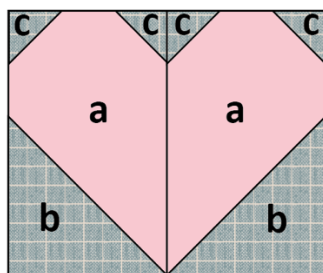

a 2in x 3in (5.1cm x 7.6cm)

b 2in (5.1cm) square

c 1in (2.5cm) square

d 1½in (3.8cm) square

e 1⅞in (4.8cm) square for 1½in (3.8cm) unfinished half-square triangles (HSTs)

f 6½in x 1in (16.5cm x 2.5cm)

Fig D Fabric positions for the patchwork

Bold numbers indicate the fabrics used (see Fig A)

The background is Fabric 1



Making a Heart Unit

6 There are three heart units, all made the same way, except that the red print changes each time. The making of the left-hand heart unit is shown in **Fig E**. The shape of the heart is created with a corner triangle technique, as follows.

Take one of the red print rectangles and place it right side up. Take one 2in square of Fabric 1 and two 1in squares of Fabric 1 and pencil mark a diagonal line on the wrong side of each square. Position the squares right sides together with the print rectangle, in the positions shown in **Fig E 1** and with the marked lines in the directions shown in the diagram. Do the same with the other red print rectangle but with the diagonal line for the 2in square in the opposite direction, as shown. Pin the squares in place and then sew along each marked line. Trim off excess fabric ¼in (6mm) outside the sewn lines and press each triangle outwards. Check the size of each unit, which needs to be 2in x 3in (5.1cm x 7.6cm).

Now sew the two halves of the heart together, as in **Fig E 2**. Press the seam open. Check the heart unit is 3½in x 3in (9cm x 7.6cm).

Make the other two heart units in the same way, using the other two red prints.

Fig E Making a heart unit

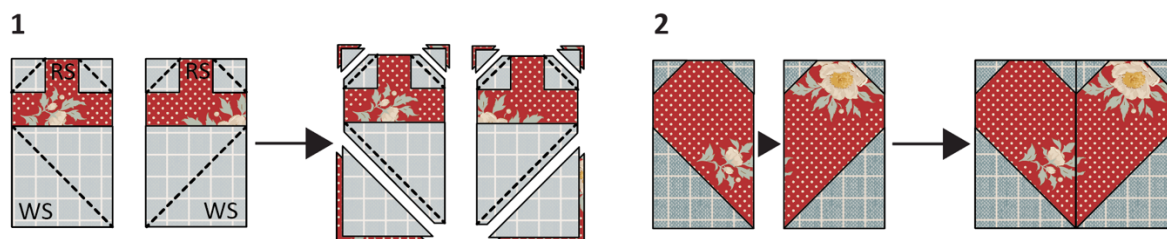

Making a Leaf Unit

7 There are two leaf units, both made the same way using half-square triangle (HST) units. The method shown in **Fig F 1** makes two HSTs at the same time, which means that you can use one HST for the first leaf unit and keep the other HST for the second leaf unit.

Take one 1 $\frac{7}{8}$ in (4.8cm) square of Fabric 1 and another square of the green print (see **Fig D** for the correct colours). On the wrong side of the lighter square, pencil mark the diagonal line. Place the two squares right sides (RS) together and sew $\frac{1}{4}$ in (6mm) away from the marked line on both sides, as shown. Cut the units apart along the marked line and press the seam (normally towards the darker fabric). Check each HST is 1 $\frac{1}{2}$ in (3.8cm) square (unfinished). Put one HST aside for the second leaf unit.

8 Make the other HSTs needed for a leaf unit and then assemble the leaf unit as in **Fig F 2**, sewing them into two rows first, with unpieced squares in between. Take care to place the HSTs in the correct positions. Press the seams of the top row in one direction and the seams of the bottom row in the opposite direction. Now sew the two rows together, matching seams neatly, and press. Finally, add the narrow strip of Fabric 1 across the base of the unit and press the seam towards the narrow strip. Check the leaf unit is 6 $\frac{1}{2}$ in x 3in (16.5cm x 7.6cm). Make another leaf unit in the same way.

Fig F Making a leaf unit

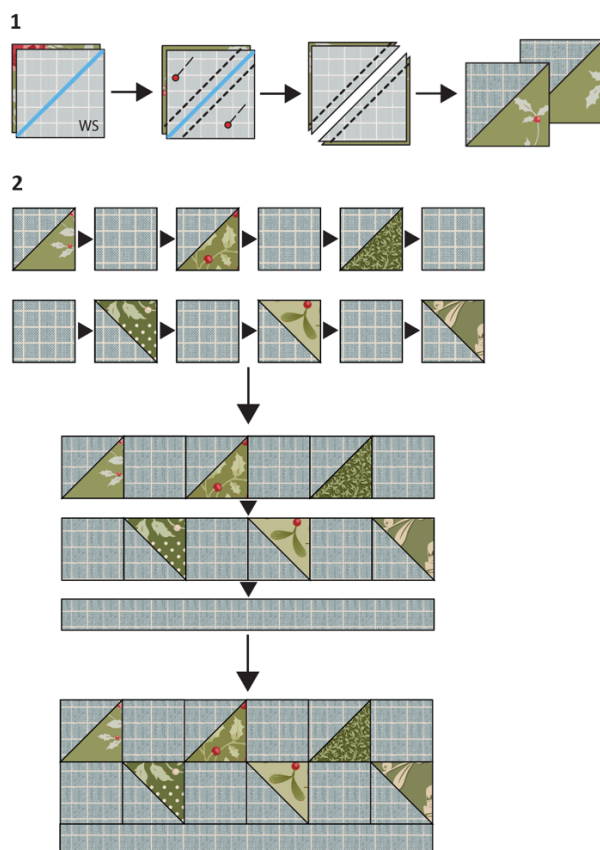

Assembling the Patchwork

9 When the heart and leaf units have been made, they can be sewn together into a row, following **Fig G**. Press the seams open or to one side. Check the patchwork strip is 21½in x 3in (54.6cm x 7.6cm).

Fig G Assembling the patchwork

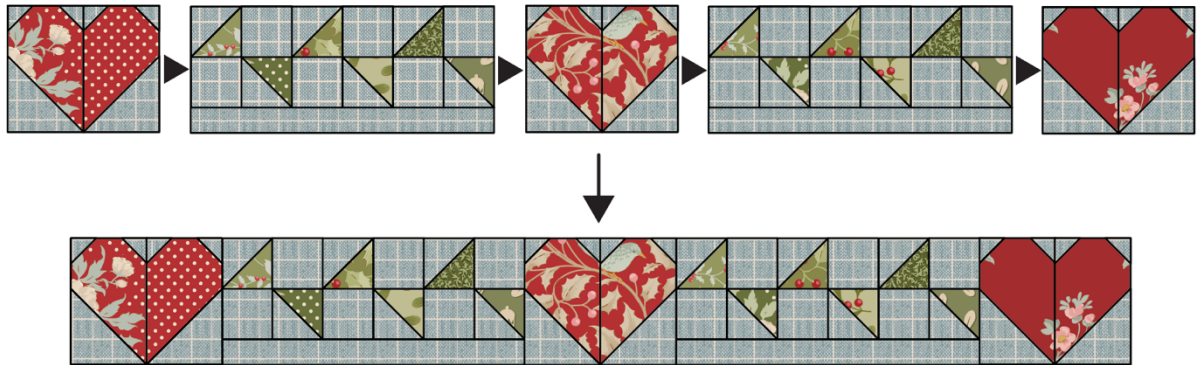

10 Now sew the border pieces in position, as shown in **Fig H**, adding the top and bottom pieces first and pressing seams towards the border. Add the side pieces and press seams outwards.

Fig H Adding the border

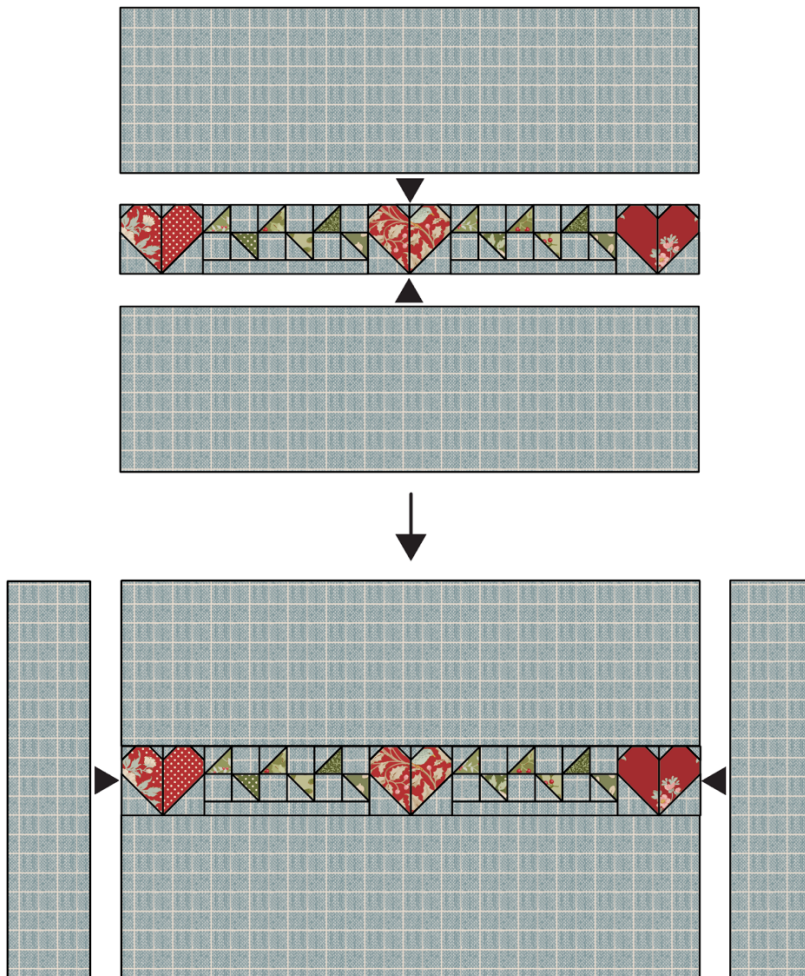

Quilting and Finishing

11 Make a quilt sandwich of the patchwork, wadding (batting) and lining fabric (if using). Quilt as desired. Trim off excess wadding and lining fabric to match the patchwork size.

12 To make up the pillow cover, take the two pieces of fabric for the pillow back and on one long edge of each piece, create a hem by turning the edge over by 1 in (2.5cm), twice. Sew the seams with matching thread and press (**Fig I**). The diagram is shown in greys, so you can use the Tilda fabric and buttons suggested in the Materials list, or those of your choice.

13 For the fastening, using your sewing machine, create five equally spaced buttonholes within the hem of one of the pieces. Sew five buttons onto the other piece, matching their positions to the buttonholes. Note: Instead of making buttonholes, you could use a hook and loop fastening, such as Velcro, to fasten the cover and sew on the buttons as a decorative feature.

14 The pillow has a bound edge, so the pieces are assembled with right sides out, as follows. On the backing, fasten the buttons into the buttonholes and place the whole piece right side down. Place the quilted patchwork on top, right side up. Make sure the outer edges of all pieces are aligned. Pin or tack (baste) the layers together and then bind as normal. As you sew the binding in place it will fix the other layers together. Press the cover and insert a pillow pad to finish.

Fig I Making up the cover

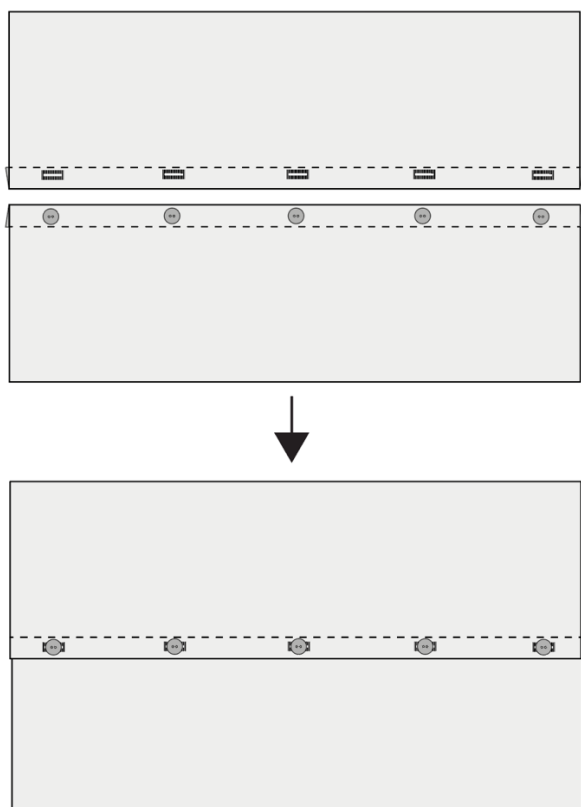

Heart Garland Pillow

(Putty white colourway)

This sweet pillow is easy to make as it is simply a rectangle of patchwork framed by a border. The pillow is perfect to brighten up the winter season and can also be used as a companion to the Dear Santa quilts. The reds and greens from the Merry Little Christmas fabric collection and its blenders contrast nicely with a background of putty white Chambray. There is a second version of the pillow where the seasonal colours are paired with a lovely plaid print. For the instructions for the other pillow, plus the two Dear Santa quilts – see tildasworld.com.

Difficulty rating *

Materials

- Fabric 1: ½yd (50cm) – Chambray putty white (160043) (background)
- Fabric 2: about 5in (13cm) square – Holly red (100621)
- Fabric 3: about 5in (13cm) square – Carol burgundy (100622)
- Fabric 4: about 5in (13cm) square – Joy red (100624)
- Fabric 5: about 5in (13cm) square – Noel moss (110145)
- Fabric 6: about 5in (13cm) square – Holly moss (100631)
- Fabric 7: about 5in (13cm) square – Eve pine (110144)
- Fabric 8: about 5in (13cm) square – Joy pine (100634)
- Fabric 9: about 5in (13cm) square – Mistletoe pistachio (100633)
- Fabric 10: about 5in (13cm) square – Paper Scenes artichoke (100635)
- Wadding (batting): 30in x 17in (76cm x 43cm)
- Lining fabric (optional): 30in x 17in (76cm x 43cm)
- Backing fabric: ⅝yd (60cm) – Holly duck egg (100626)
- Binding fabric: ¼yd (25cm) – Gingham red (160087)
- Piecing and quilting threads
- Quilter's ruler, rotary cutter and mat
- Five buttons for fastening (optional) – Merry Little Christmas buttons 16mm (400072)
- Pillow pad to fit cover

Fabric Notes

All of the fabrics, apart from the background, only need small pieces, so you may have fabrics left over from your other Merry Little Christmas projects.

Finished Size

27½in x 15in (70cm x 38cm)

General Notes

- Fabric quantities are based on a usable width of 42in (107cm), unless otherwise stated.
- Measurements are in imperial inches with metric conversions in brackets – use only *one* system throughout (preferably inches). Width measurements are generally given first.
- Press fabric before cutting and trim as needed to square up the fabric pattern/weave, using a quilting ruler to cut the top raw edge at 90 degrees to the selvages.
- Use ¼in (6mm) seams unless otherwise instructed.
- Read all the instructions through before you start.
- Always make one complete block as a test before going on to make the remaining blocks.
- Abbreviations: RS = right side; WS = wrong side; HST = half-square triangle.

Pillow Layout

1 The pillow layout consists of a strip of patchwork made up of three heart units and two leaf units and the patchwork is framed by a border on all sides. Refer to **Fig A** for the fabrics used and **Fig B** for the pillow layout.

Fig A Fabric swatches (Heart Garland Pillow – putty white)

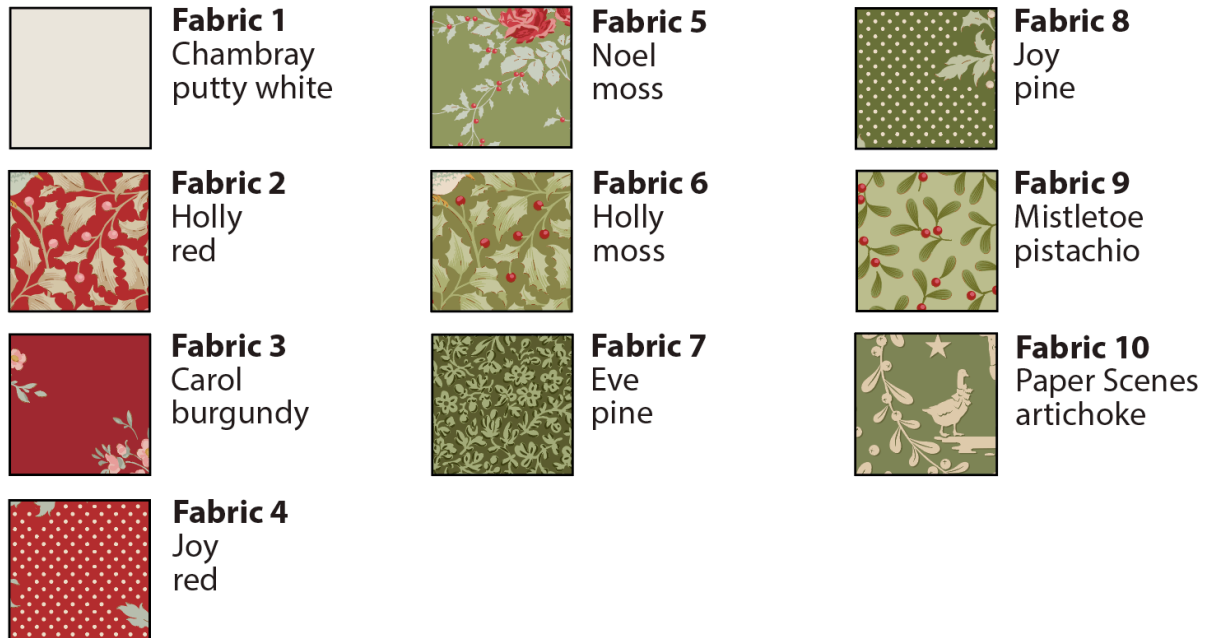
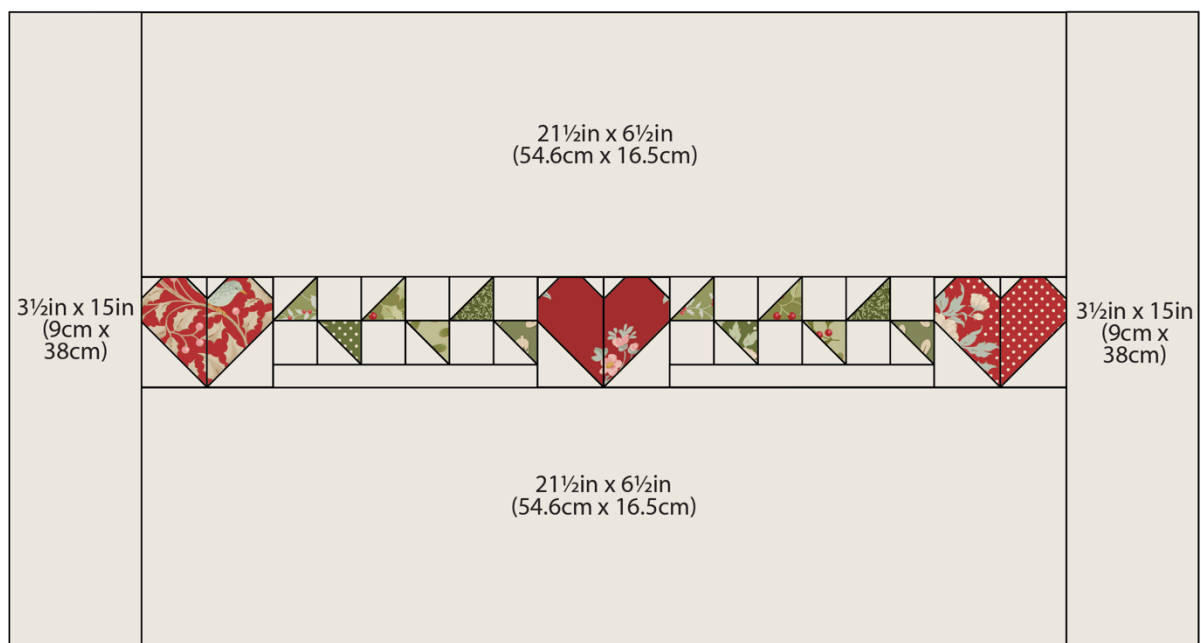

Fig B Pillow layout



Cutting Out

2 From Fabric 1, cut the border strips first, as follows and shown in **Fig B**.

- Two strips 21 1/2 in x 6 1/2 in (54.6 cm x 16.5 cm) for the top and bottom borders.
- Two strips 3 1/2 in x 15 in (9 cm x 38 cm) for the side borders.

3 For the patchwork, follow **Fig C** to cut the sizes given and **Fig D** for the fabric positions. You will need to cut pieces for three heart units and two leaf units.

4 From the backing fabric cut two pieces 28in x 11in (71cm x 28cm).

5 Cut the binding fabric into three 2½in (6.4cm) x width of fabric strips. Sew together end to end and press seams open. Press the binding in half along the length, wrong sides together.

Fig C Cut measurements for the patchwork

Sizes include ¼in (6mm) seam allowances

All pieces to be cut initially as squares or rectangles

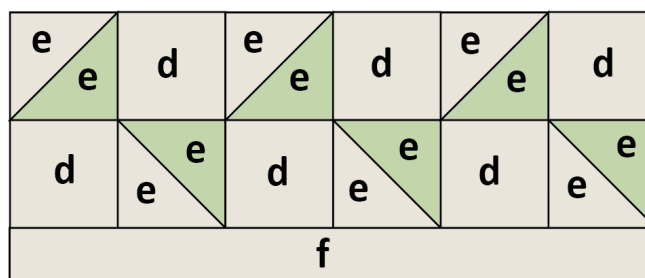
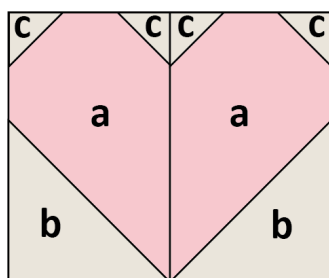

a 2in x 3in (5.1cm x 7.6cm)

b 2in (5.1cm) square

c 1in (2.5cm) square

d 1½in (3.8cm) square

e 1½in (4.8cm) square for 1½in (3.8cm) unfinished half-square triangles (HSTs)

f 6½in x 1in (16.5cm x 2.5cm)

Fig D Fabric positions for the patchwork

Bold numbers indicate the fabrics used (see Fig A)

The background is Fabric 1



Making a Heart Unit

6 There are three heart units, all made the same way, except that the red print changes each time. The making of the left-hand heart unit is shown in **Fig E**. The shape of the heart is created with a corner triangle technique, as follows.

Take one of the red print rectangles and place it right side up. Take one 2in square of Fabric 1 and two 1in squares of Fabric 1 and pencil mark a diagonal line on the wrong side of each square. Position the squares right sides together with the print rectangle, in the positions shown in **Fig E 1** and with the marked lines in the directions shown in the diagram. Do the same with the other red print rectangle but with the diagonal line for the 2in square in the opposite direction, as shown. Pin the squares in place and then sew along each marked line. Trim off excess fabric ¼in (6mm) outside the sewn lines and press each triangle outwards. Check the size of each unit, which needs to be 2in x 3in (5.1cm x 7.6cm).

Now sew the two halves of the heart together, as in **Fig E 2**. Press the seam open. Check the heart unit is 3½in x 3in (9cm x 7.6cm).

Make the other two heart units in the same way, using the other two red prints.

Fig E Making a heart unit

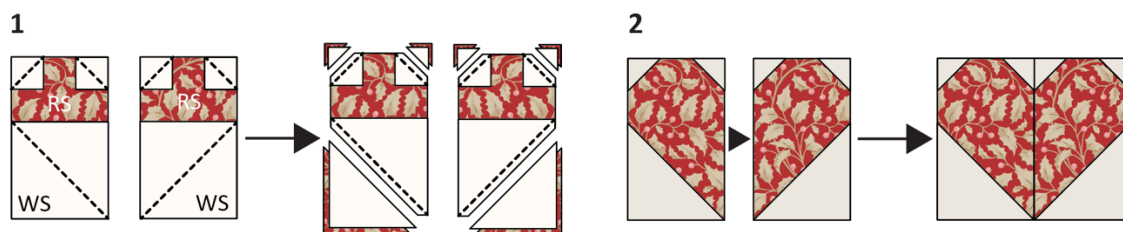

Making a Leaf Unit

7 There are two leaf units, both made the same way using half-square triangle (HST) units. The method shown in **Fig F 1** makes two HSTs at the same time, which means that you can use one HST for the first leaf unit and keep the other HST for the second leaf unit.

Take one $1\frac{7}{8}$ in (4.8cm) square of Fabric 1 and another square of the green print (see **Fig D** for the correct colours). On the wrong side of the lighter square, pencil mark the diagonal line. Place the two squares right sides (RS) together and sew $\frac{1}{4}$ in (6mm) away from the marked line on both sides, as shown. Cut the units apart along the marked line and press the seam (normally towards the darker fabric). Check each HST is $1\frac{1}{2}$ in (3.8cm) square (unfinished). Put one HST aside for the second leaf unit.

8 Make the other HSTs needed for a leaf unit and then assemble the leaf unit as in **Fig F 2**, sewing them into two rows first, with unpieced squares in between. Take care to place the HSTs in the correct positions. Press the seams of the top row in one direction and the seams of the bottom row in the opposite direction. Now sew the two rows together, matching seams neatly, and press. Finally, add the narrow strip of Fabric 1 across the base of the unit and press the seam towards the narrow strip. Check the leaf unit is $6\frac{1}{2}$ in x 3in (16.5cm x 7.6cm). Make another leaf unit in the same way.

Fig F Making a leaf unit

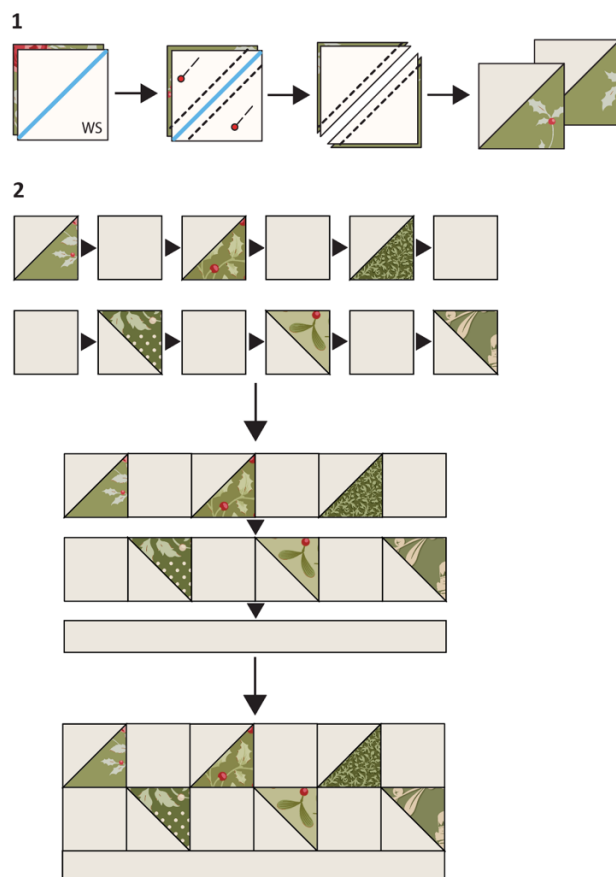

Assembling the Patchwork

9 When the heart and leaf units have been made, they can be sewn together into a row, following **Fig G**. Press the seams open or to one side. Check the patchwork strip is 21½in x 3in (54.6cm x 7.6cm).

Fig G Assembling the patchwork

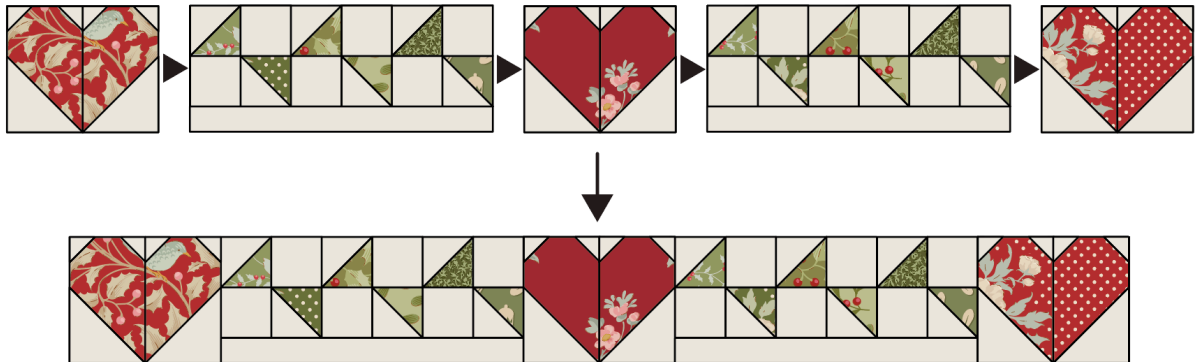

10 Now sew the border pieces in position, as shown in **Fig H**, adding the top and bottom pieces first and pressing seams towards the border. Add the side pieces and press seams outwards.

Fig H Adding the border

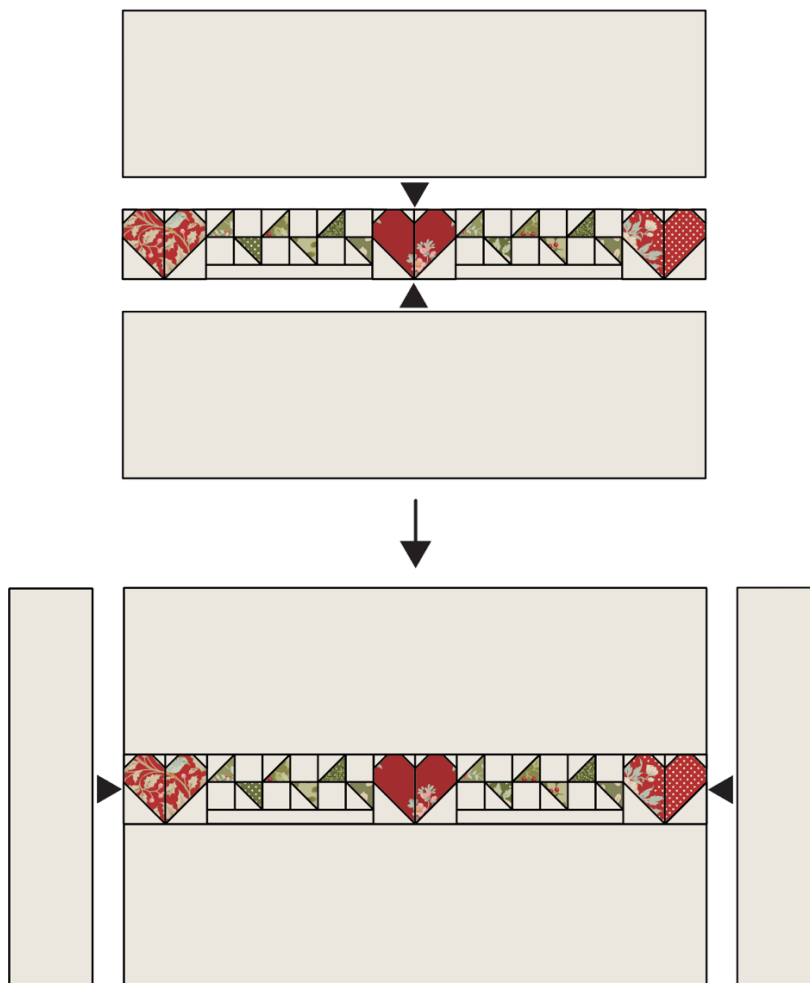

Quilting and Finishing

11 Make a quilt sandwich of the patchwork, wadding (batting) and lining fabric (if using). Quilt as desired. Trim off excess wadding and lining fabric to match the patchwork size.

12 To make up the pillow cover, take the two pieces of fabric for the pillow back and on one long edge of each piece, create a hem by turning the edge over by 1 in (2.5cm), twice. Sew the seams with matching thread and press (**Fig I**). The diagram is shown in greys, so you can use the Tilda fabric and buttons suggested in the Materials list, or those of your choice.

13 For the fastening, using your sewing machine, create five equally spaced buttonholes within the hem of one of the pieces. Sew five buttons onto the other piece, matching their positions to the buttonholes. Note: Instead of making buttonholes, you could use a hook and loop fastening, such as Velcro, to fasten the cover and sew on the buttons as a decorative feature.

14 The pillow has a bound edge, so the pieces are assembled with right sides out, as follows. On the backing, fasten the buttons into the buttonholes and place the whole piece right side down. Place the quilted patchwork on top, right side up. Make sure the outer edges of all pieces are aligned. Pin or tack (baste) the layers together and then bind as normal. As you sew the binding in place it will fix the other layers together. Press the cover and insert a pillow pad to finish.

Fig I Making up the cover

