



Puddle Frog Pillow (coral colourway)

This pillow features three charming frogs all in a row – perfect to accompany the Puddle Frog Quilt, or just a fun home accessory in its own right. The fabrics are from the Gardenlife and Chambray collections. There are two other pillow colourways, made in the same way – see tildasworld.com for the pillows and quilt instructions.

Materials

- Fabric 1: 12in (30.5cm) square – Bowl Peony green (100314)
- Fabric 2: 12in (30.5cm) square – Striped Petunia green (100313)
- Fabric 3: 12in (30.5cm) square – Poppies grey green (100312)
- Fabric 4: $\frac{3}{8}$ yd (40cm) – Chambray coral (160014)
- Fabric 5: 9in (23cm) square – Chambray olive (160012)
- Fabric 6: 9in (23cm) square – Chambray sage (160011)
- Fabric 7: 9in (23cm) square – Chambray teal (160004)
- Wadding (batting): 39in x 14in (99cm x 35.5cm)
- Lining fabric (optional): 39in x 14in (99cm x 35.5cm)
- Back fabric: two pieces 21in x 12 $\frac{1}{4}$ in (53.3cm x 31.1cm) – Medium Dots teal (130001)
- Binding fabric: $\frac{1}{4}$ yd (25cm) – Striped Petunia coral (100309)
- Piecing and quilting threads, plus black embroidery cotton (floss) for eyes
- Four buttons for closing the back of the pillow
- Pad to fit pillow

Finished Size

36 $\frac{1}{2}$ in x 12 $\frac{1}{4}$ in (92.7cm x 31.1cm)

General Notes

- Fabric quantities are based on a usable width of 42in (107cm), unless otherwise stated.
- Measurements are in imperial inches with metric conversions in brackets – use only *one* system throughout (preferably inches). Width measurements are generally given first.
- Press all fabrics before cutting.
- Use $\frac{1}{4}$ in (6mm) seams unless otherwise instructed.
- Read all the instructions through before you start.

Pillow Layout

1 The pillow uses a frog block in three different colourways. Narrow border strips are used at the top and bottom of the pillow. See **Fig A** for the fabrics used and **Fig B** for the pillow layout and positions of the fabrics.

Fig A Fabric swatches (Puddle Frog Pillow – coral colourway)

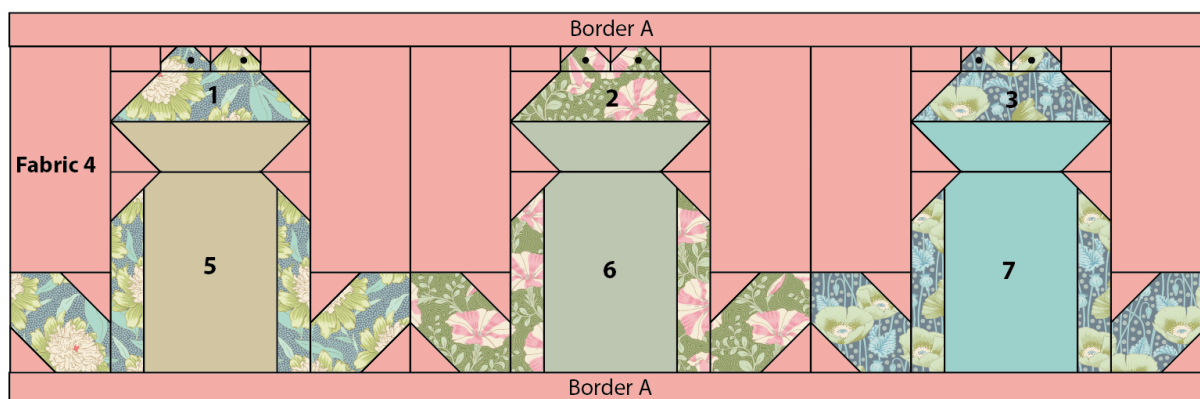

Fig B Pillow layout and fabric positions

Cutting Out

2 Cut the strips for the two Border A strips first from Fabric 4 (Chambray coral), cutting two strips $36\frac{1}{2}\text{in} \times 1\frac{1}{2}\text{in}$ (92.7cm x 3.8cm).

3 Fig C gives the measurements of the cut pieces needed for the block, so follow these measurements carefully as you cut the fabric pieces.

4 Cut the binding fabric into three strips $2\frac{1}{2}\text{in}$ (6.4cm) x width of fabric. Sew them together end to end and press seams open. Press in half along the length, wrong sides together.

Fig C Layout and cutting for the blocks

Sizes include seam allowances. All pieces to be cut initially as squares or rectangles

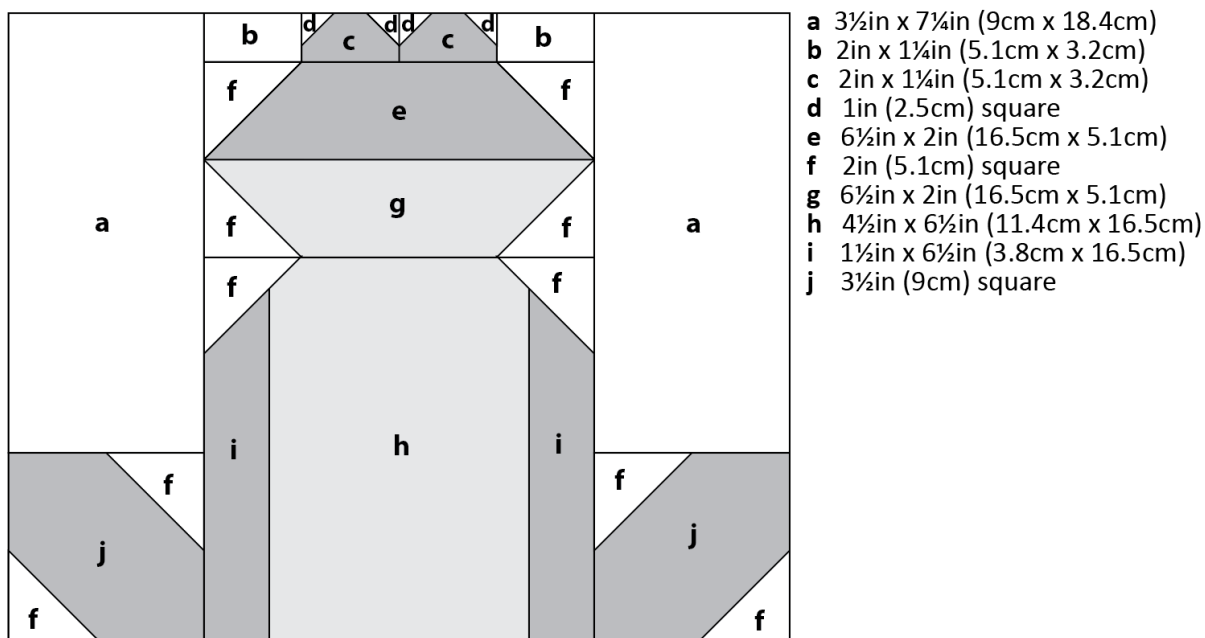

Making a Frog Block

5 There are three frog blocks in different colourways. The frog on the left-hand side will be described in detail. The block uses corner triangle units in various places to create sharp

corners. These are all made using the same technique but changing the fabrics used and the sizes as needed. **Fig D** shows the process in detail for the eyes.

Take a print piece (**c**) and place it right side up. Take two background fabric squares (**d**) and pencil mark a diagonal line on the wrong side of each square. Place the squares right sides together with the print square, aligning them in the top two corners and with the marked lines in the directions shown in **Fig D**. Sew along the marked lines. Trim off excess fabric $\frac{1}{4}$ in (6mm) outside the sewn lines and then press the triangles outwards. Check the unit is 2in x 1 $\frac{1}{4}$ in (5.1cm x 3.2cm). Make another unit like this.

Fig D Making corner square triangles



6 Using the same technique, create corner triangles on piece **e** and piece **g**, using the **f** squares of background fabric. Now sew the head unit together as shown in **Fig E** and press the seams.

Fig E Making the head unit

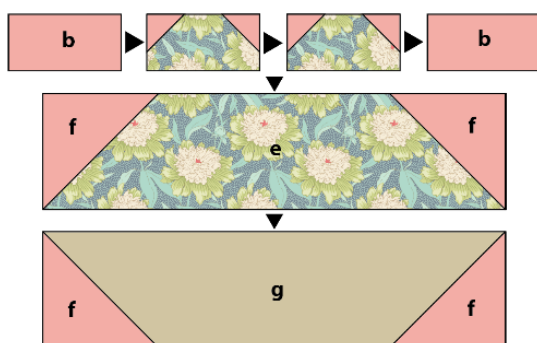

7 To make the body, sew the pieces together (**i/h/i**) as shown in **Fig F**. Now, using the same corner triangle technique add the **f** pieces – note that these triangles are formed over more than one fabric piece.

Fig F Making the body unit

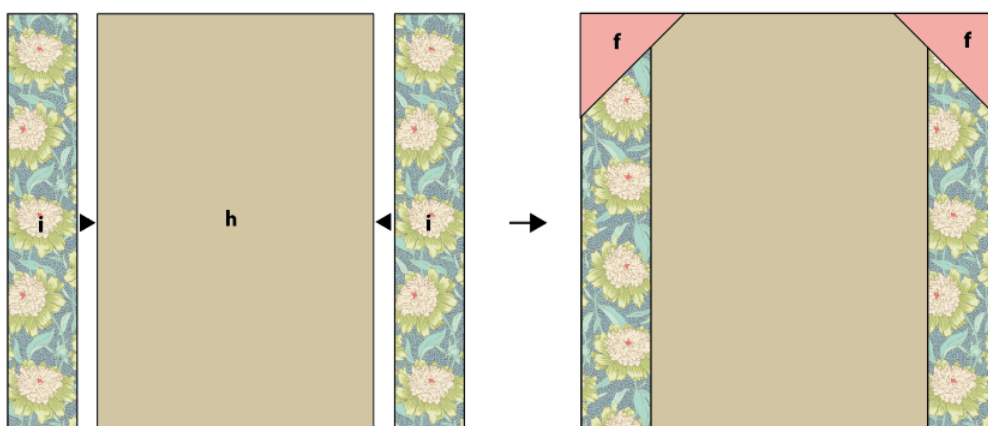

8 To make the legs, create corner triangles on the print square (**j**), using the background squares (**f**), positioning them as shown in **Fig G 1**. Add the rectangle (**a**) to the top. Make the other leg the same way but position the **f** squares as in **Fig G 2**.

Fig G Making the leg units

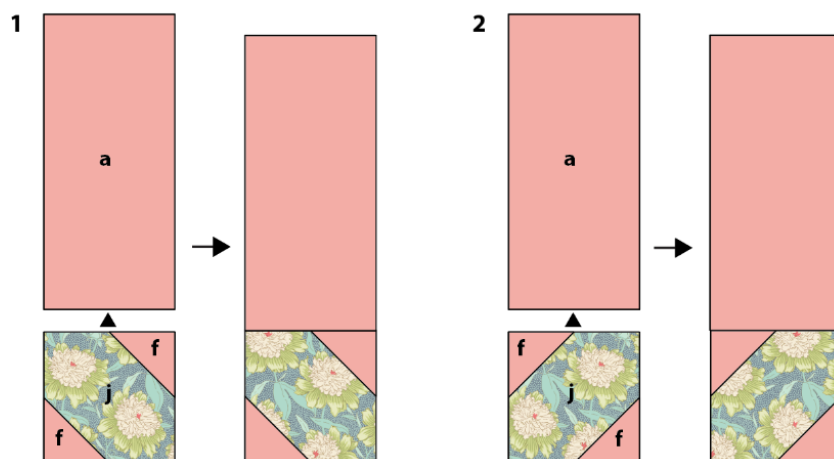

9 To assemble the block, take all the units you have made and sew them together, following the stages in **Fig H**. Once sewn, check the block is 12½in x 10¼in (31.8cm x 26cm).

Fig H Assembling the Frog block

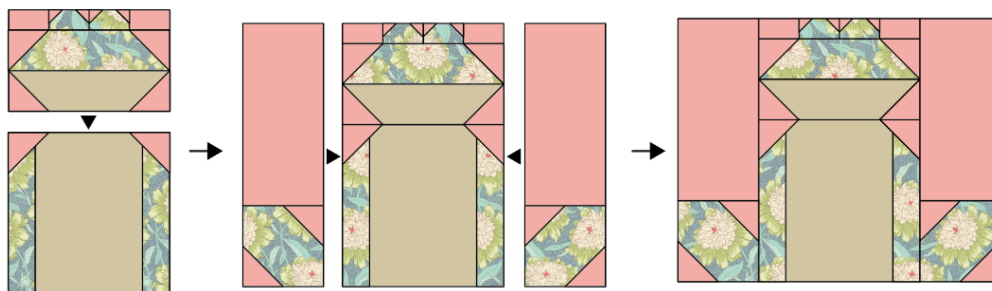

10 Make the other two Frog blocks, following **Fig B** to choose the correct fabrics.

Assembling the Pillow

11 When all of the blocks are made, sew them together in a row and press the seams. Add the Border A pieces to the top and bottom of the pillow and press seams outwards.

12 To finish the patchwork, embroider the eyes on the frogs (**Fig I**), using six strands of black stranded cotton and working French knots with the yarn wrapped twice around the needle.

Fig I Adding the eyes

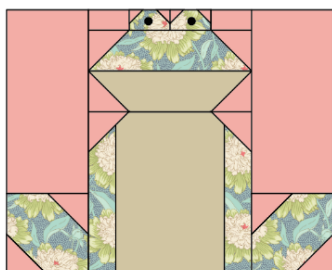

Quilting and Finishing

13 Make a quilt sandwich of the patchwork, wadding (batting) and lining fabric (if using). Quilt as desired. Trim off excess wadding and lining fabric to match the patchwork.

14 To make up the pillow cover, on both pieces of fabric for the pillow back, create a hem along one short side of each piece, by turning the edge over by 1 in (2.5cm), twice. Sew the seam with matching thread and press.

15 For the fastening, create four equally spaced buttonholes using your sewing machine within the hem of the right-hand piece (**Fig J**). Sew four buttons on the left-hand piece, matching their positions to the buttonholes. Note: Instead of buttons, you could use a hook and loop fastening, such as Velcro, if you prefer.

Fig J Making up with a button fastening

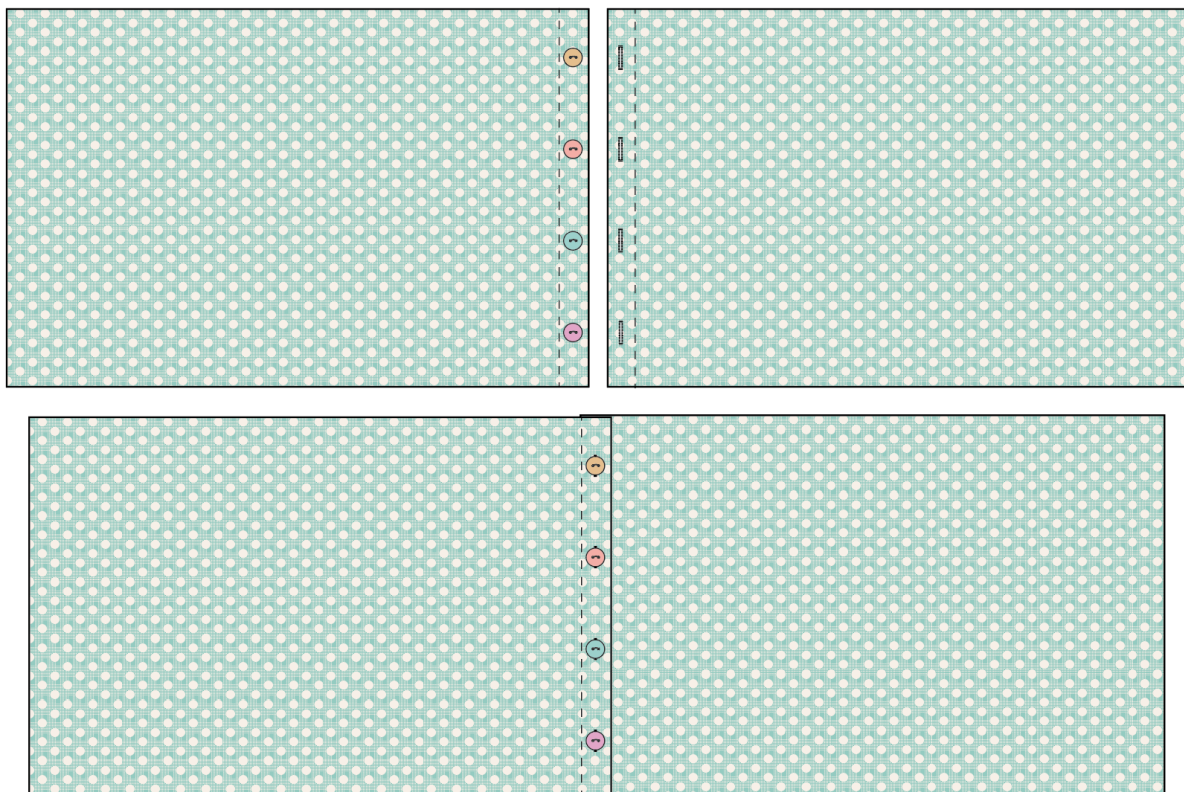

16 The pillow has a bound edge, so the pieces are assembled with right sides out, as follows. Place the quilted patchwork right side down. On the backing, fasten the buttons into the buttonholes and then place the whole piece on top of the patchwork, right side up. Check it is the same length as the patchwork, trimming if need be. Make sure the outer edges of all pieces are aligned. Pin the layers together and then bind as normal. As you sew the binding in place it will fix the other layers together. Press the cover and insert a pillow pad to finish.

Puddle Frog Pillow (lavender colourway)

This pillow features three charming frogs all in a row – perfect to accompany the Puddle Frog Quilt, or just a fun home accessory in its own right. The fabrics are from the Gardenlife and Chambray collections. There are two other pillow colourways, made in the same way – see tildasworld.com for the pillows and quilt instructions.

Materials

- Fabric 1: 12in (30.5cm) square – Bowl Peony blue (100320)
- Fabric 2: 12in (30.5cm) square – Striped Petunia coral (100309)
- Fabric 3: 12in (30.5cm) square – Poppies lilac (100306)
- Fabric 4: $\frac{3}{4}$ yd (40cm) – Chambray lavender (160009)
- Fabric 5: 9in (23cm) square – Chambray teal (160004)
- Fabric 6: 9in (23cm) square – Chambray coral (160014)
- Fabric 7: 9in (23cm) square – Chambray cerise (160013)
- Wadding (batting): 39in x 14in (99cm x 35.5cm)
- Lining fabric (optional): 39in x 14in (99cm x 35.5cm)
- Back fabric: two pieces 21in x 12 $\frac{1}{4}$ in (53.3cm x 31.1cm) – Medium Dots lilac (130009)
- Binding fabric: $\frac{1}{4}$ yd (25cm) – Gardenlife plum (100310)
- Piecing and quilting threads, plus black embroidery cotton (floss) for eyes
- Four buttons for closing the back of the pillow
- Pad to fit pillow

Finished Size

36 $\frac{1}{2}$ in x 12 $\frac{1}{4}$ in (92.7cm x 31.1cm)

General Notes

- Fabric quantities are based on a usable width of 42in (107cm), unless otherwise stated.
- Measurements are in imperial inches with metric conversions in brackets – use only *one* system throughout (preferably inches). Width measurements are generally given first.
- Press all fabrics before cutting.
- Use $\frac{1}{4}$ in (6mm) seams unless otherwise instructed.
- Read all the instructions through before you start.

Pillow Layout

1 The pillow uses a frog block in three different colourways. Narrow border strips are used at the top and bottom of the pillow. See **Fig A** for the fabrics used and **Fig B** for the pillow layout and positions of the fabrics.

Fig A Fabric swatches (Puddle Frog Pillow – lavender colourway)

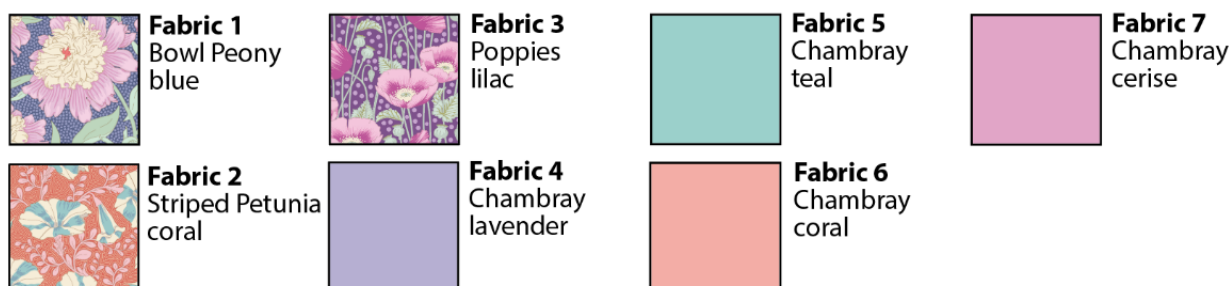
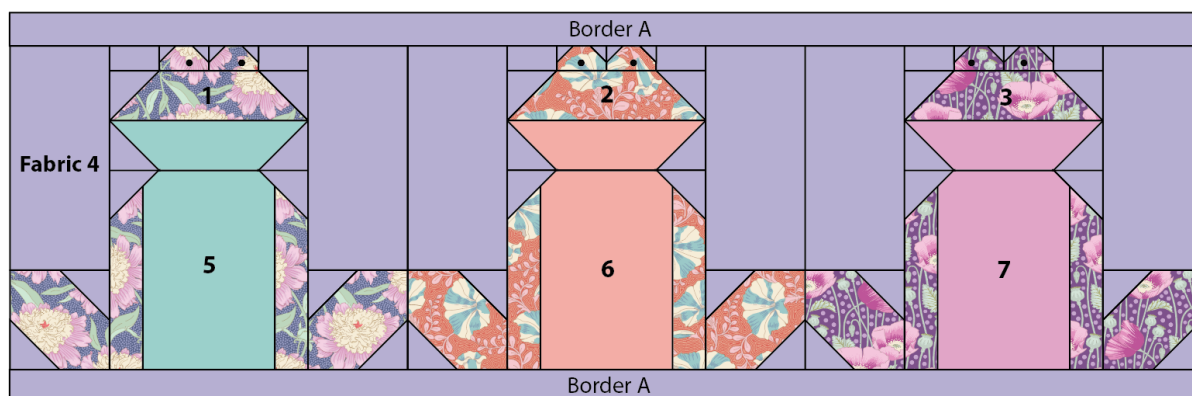

Fig B Pillow layout and fabric positions

Cutting Out

2 Cut the strips for the two Border A strips first from Fabric 4 (Chambray lavender), cutting two strips 36½in x 1½in (92.7cm x 3.8cm).

3 Fig C gives the measurements of the cut pieces needed for the block, so follow these measurements carefully as you cut the fabric pieces.

4 Cut the binding fabric into three strips 2½in (6.4cm) x width of fabric. Sew them together end to end and press seams open. Press in half along the length, wrong sides together.

Fig C Layout and cutting for the blocks

Sizes include seam allowances. All pieces to be cut initially as squares or rectangles

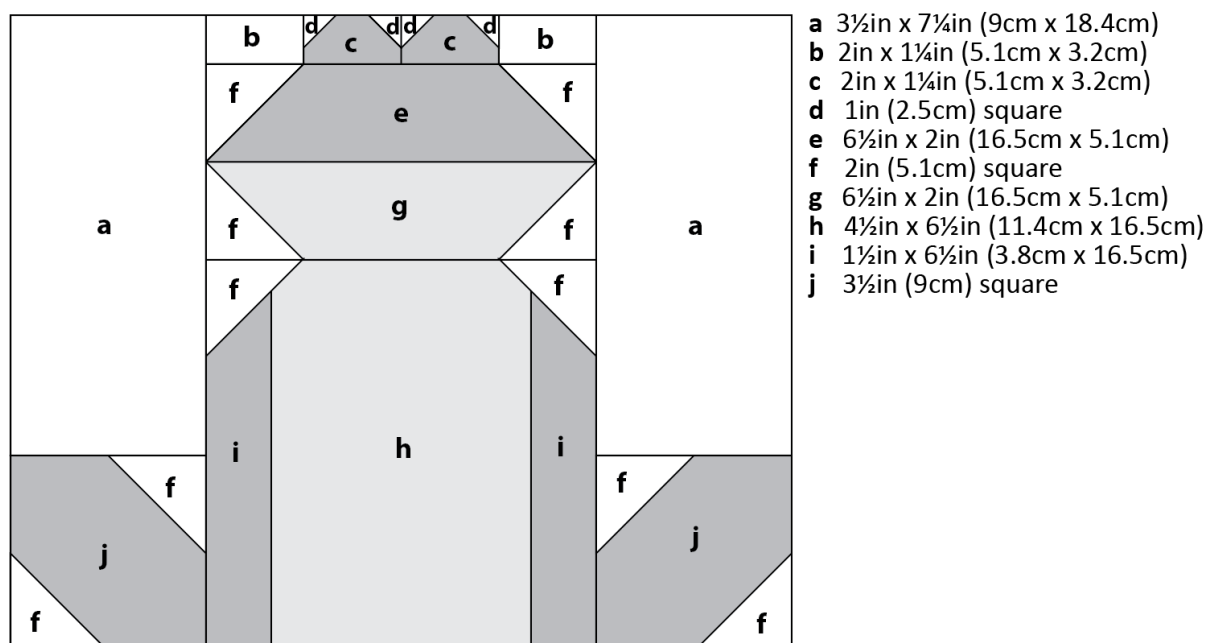

Making a Frog Block

5 There are three frog blocks in different colourways. The frog on the left-hand side will be described in detail. The block uses corner triangle units in various places to create sharp

corners. These are all made using the same technique but changing the fabrics used and the sizes as needed. **Fig D** shows the process in detail for the eyes.

Take a print piece (**c**) and place it right side up. Take two background fabric squares (**d**) and pencil mark a diagonal line on the wrong side of each square. Place the squares right sides together with the print square, aligning them in the top two corners and with the marked lines in the directions shown in **Fig D**. Sew along the marked lines. Trim off excess fabric $\frac{1}{4}$ in (6mm) outside the sewn lines and then press the triangles outwards. Check the unit is 2in x 1 $\frac{1}{4}$ in (5.1cm x 3.2cm). Make another unit like this.

Fig D Making corner square triangles



6 Using the same technique, create corner triangles on piece **e** and piece **g**, using the **f** squares of background fabric. Now sew the head unit together as shown in **Fig E** and press the seams.

Fig E Making the head unit

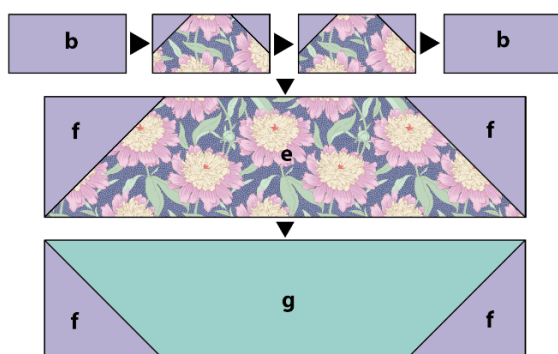

7 To make the body, sew the pieces together (**i/h/i**) as shown in **Fig F**. Now, using the same corner triangle technique add the **f** pieces – note that these triangles are formed over more than one fabric piece.

Fig F Making the body unit

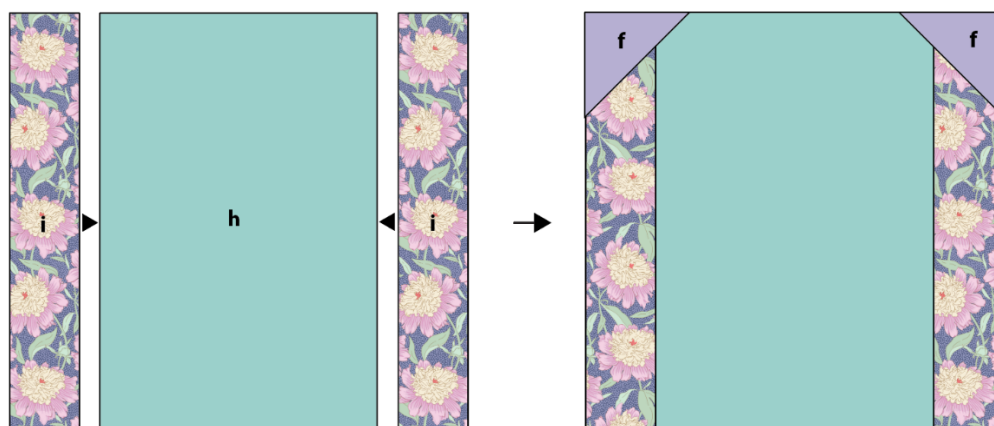

8 To make the legs, create corner triangles on the print square (**j**), using the background squares (**f**), positioning them as shown in **Fig G 1**. Add the rectangle (**a**) to the top. Make the other leg the same way but position the **f** squares as in **Fig G 2**.

Fig G Making the leg units

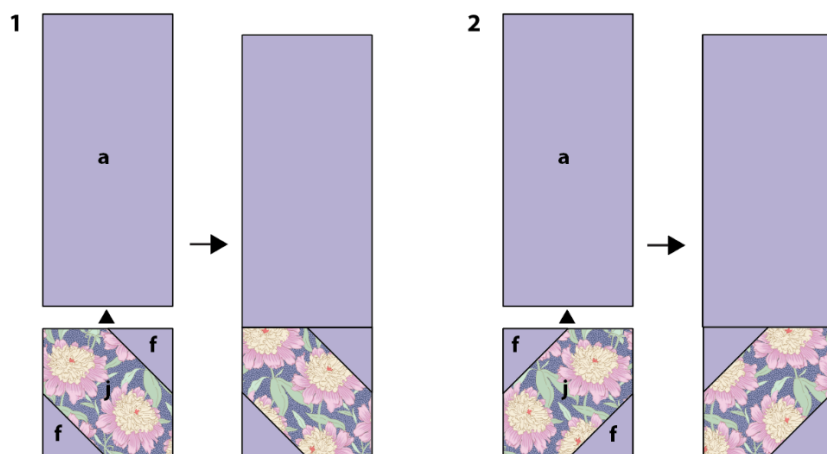

9 To assemble the block, take all the units you have made and sew them together, following the stages in **Fig H**. Once sewn, check the block is 12½in x 10¼in (31.8cm x 26cm).

Fig H Assembling the Frog block

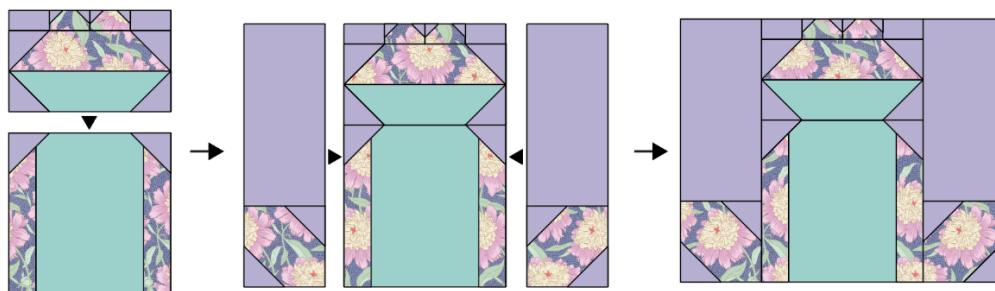

10 Make the other two Frog blocks, following **Fig B** to choose the correct fabrics.

Assembling the Pillow

11 When all of the blocks are made, sew them together in a row and press the seams. Add the Border A pieces to the top and bottom of the pillow and press seams outwards.

12 To finish the patchwork, embroider the eyes on the frogs (**Fig I**), using six strands of black stranded cotton and working French knots with the yarn wrapped twice around the needle.

Fig I Adding the eyes

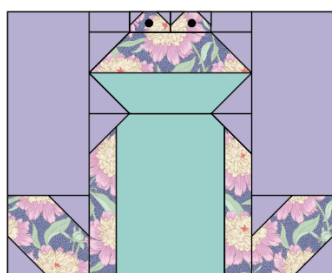

Quilting and Finishing

13 Make a quilt sandwich of the patchwork, wadding (batting) and lining fabric (if using). Quilt as desired. Trim off excess wadding and lining fabric to match the patchwork.

14 To make up the pillow cover, on both pieces of fabric for the pillow back, create a hem along one short side of each piece, by turning the edge over by 1 in (2.5cm), twice. Sew the seam with matching thread and press.

15 For the fastening, create four equally spaced buttonholes using your sewing machine within the hem of the right-hand piece (**Fig J**). Sew four buttons on the left-hand piece, matching their positions to the buttonholes. Note: Instead of buttons, you could use a hook and loop fastening, such as Velcro, if you prefer.

Fig J Making up with a button fastening

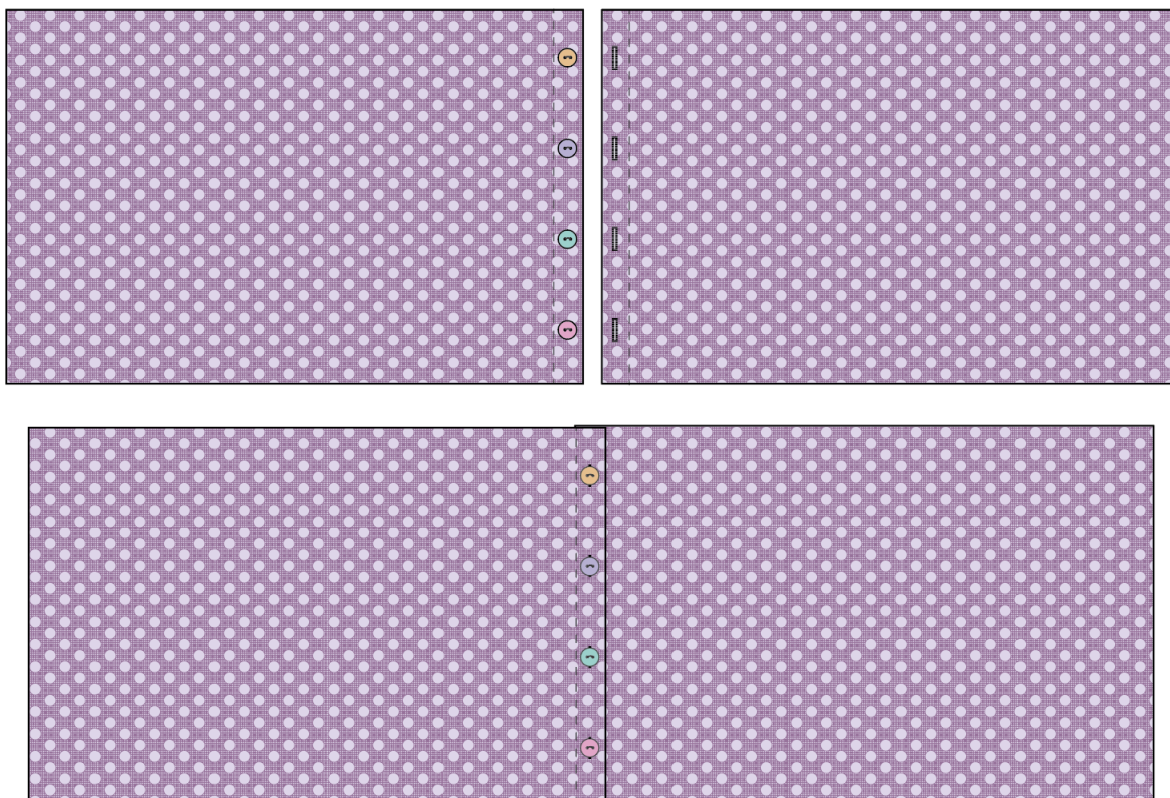

16 The pillow has a bound edge, so the pieces are assembled with right sides out, as follows. Place the quilted patchwork right side down. On the backing, fasten the buttons into the buttonholes and then place the whole piece on top of the patchwork, right side up. Check it is the same length as the patchwork, trimming if need be. Make sure the outer edges of all pieces are aligned. Pin the layers together and then bind as normal. As you sew the binding in place it will fix the other layers together. Press the cover and insert a pillow pad to finish.

Puddle Frog Pillow (warm yellow colourway)

This pillow features three charming frogs all in a row – perfect to accompany the Puddle Frog Quilt, or just a fun home accessory in its own right. The fabrics are from the Gardenlife and Chambray collections. There are two other pillow colourways, made in the same way – see tildasworld.com for the pillows and quilt instructions.

Materials

- Fabric 1: 12in (30.5cm) square – Striped Petunia blue (100316)
- Fabric 2: 12in (30.5cm) square – Gardenlife blue (100318)
- Fabric 3: 12in (30.5cm) square – Poppies blue (100319)
- Fabric 4: $\frac{3}{8}$ yd (40cm) – Chambray warm yellow (160015)
- Fabric 5: 9in (23cm) square – Chambray blue (160008)
- Fabric 6: 9in (23cm) square – Chambray dark blue (160007)
- Fabric 7: 9in (23cm) square – Chambray teal (160004)
- Wadding (batting): 39in x 14in (99cm x 35.5cm)
- Lining fabric (optional): 39in x 14in (99cm x 35.5cm)
- Back fabric: two pieces 21in x 12 $\frac{1}{4}$ in (53.3cm x 31.1cm) – Medium Dots flaxen yellow (130029)
- Binding fabric: $\frac{1}{4}$ yd (25cm) – Nasturtium mustard (100304)
- Piecing and quilting threads, plus black embroidery cotton (floss) for eyes
- Four buttons for closing the back of the pillow
- Pad to fit pillow

Finished Size

36 $\frac{1}{2}$ in x 12 $\frac{1}{4}$ in (92.7cm x 31.1cm)

General Notes

- Fabric quantities are based on a usable width of 42in (107cm), unless otherwise stated.
- Measurements are in imperial inches with metric conversions in brackets – use only *one* system throughout (preferably inches). Width measurements are generally given first.
- Press all fabrics before cutting.
- Use $\frac{1}{4}$ in (6mm) seams unless otherwise instructed.
- Read all the instructions through before you start.

Pillow Layout

1 The pillow uses a frog block in three different colourways. Narrow border strips are used at the top and bottom of the pillow. See **Fig A** for the fabrics used and **Fig B** for the pillow layout and positions of the fabrics.

Fig A Fabric swatches (Puddle Frog Pillow – warm yellow colourway)

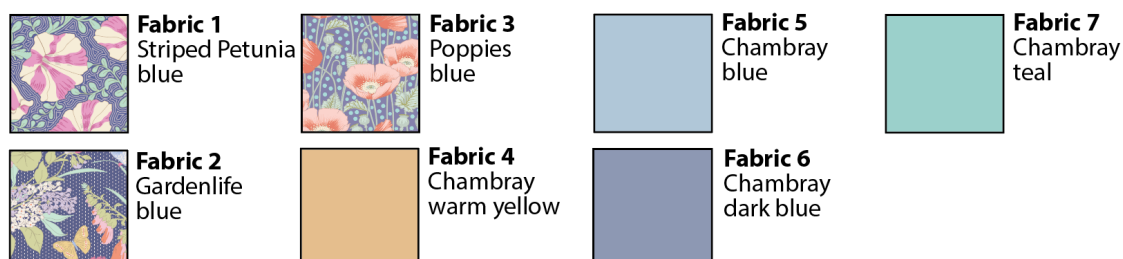
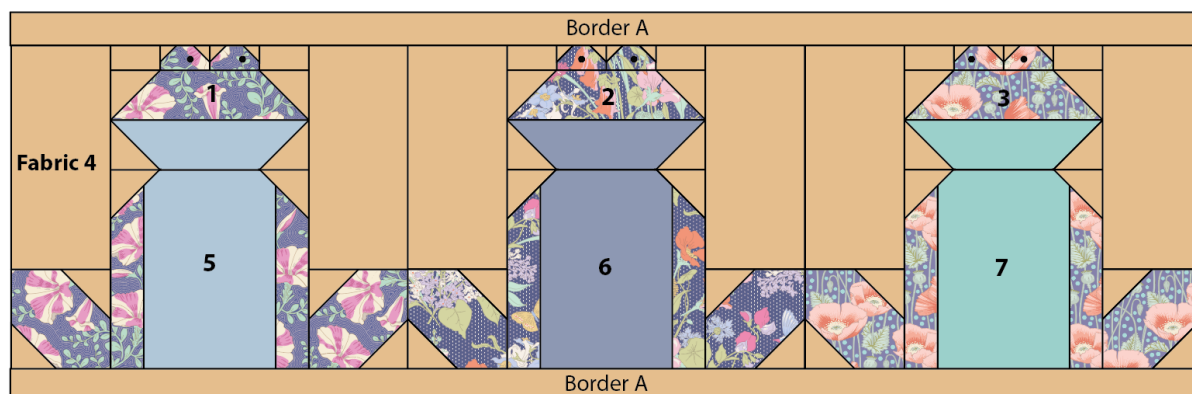

Fig B Pillow layout and fabric positions

Cutting Out

2 Cut the strips for the two Border A strips first from Fabric 4 (Chambray warm yellow), cutting two strips $36\frac{1}{2}$ in x $1\frac{1}{2}$ in (92.7cm x 3.8cm).

3 Fig C gives the measurements of the cut pieces needed for the block, so follow these measurements carefully as you cut the fabric pieces.

4 Cut the binding fabric into three strips $2\frac{1}{2}$ in (6.4cm) x width of fabric. Sew them together end to end and press seams open. Press in half along the length, wrong sides together.

Fig C Layout and cutting for the blocks

Sizes include seam allowances. All pieces to be cut initially as squares or rectangles

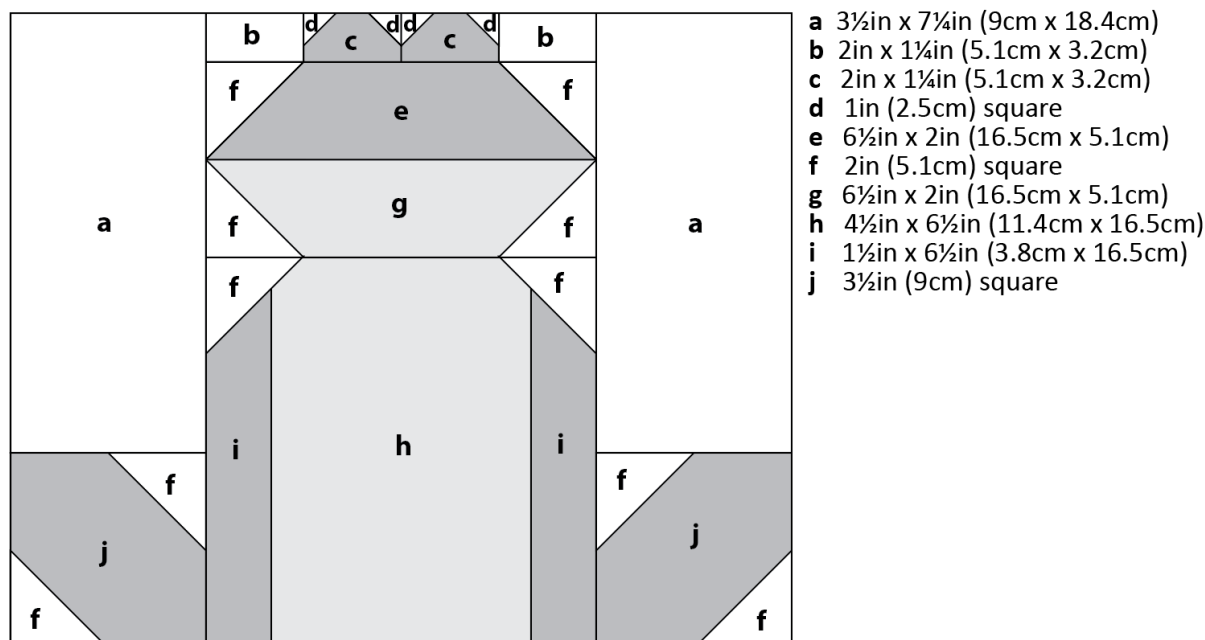

Making a Frog Block

5 There are three frog blocks in different colourways. The frog on the left-hand side will be described in detail. The block uses corner triangle units in various places to create sharp

corners. These are all made using the same technique but changing the fabrics used and the sizes as needed. **Fig D** shows the process in detail for the eyes.

Take a print piece (**c**) and place it right side up. Take two background fabric squares (**d**) and pencil mark a diagonal line on the wrong side of each square. Place the squares right sides together with the print square, aligning them in the top two corners and with the marked lines in the directions shown in **Fig D**. Sew along the marked lines. Trim off excess fabric $\frac{1}{4}$ in (6mm) outside the sewn lines and then press the triangles outwards. Check the unit is 2in x 1 $\frac{1}{4}$ in (5.1cm x 3.2cm). Make another unit like this.

Fig D Making corner square triangles

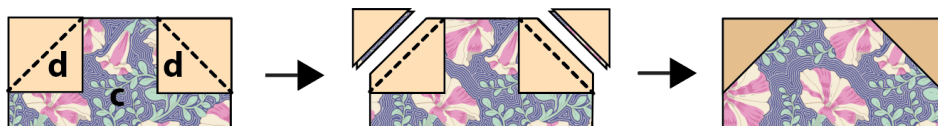

6 Using the same technique, create corner triangles on piece **e** and piece **g**, using the **f** squares of background fabric. Now sew the head unit together as shown in **Fig E** and press the seams.

Fig E Making the head unit

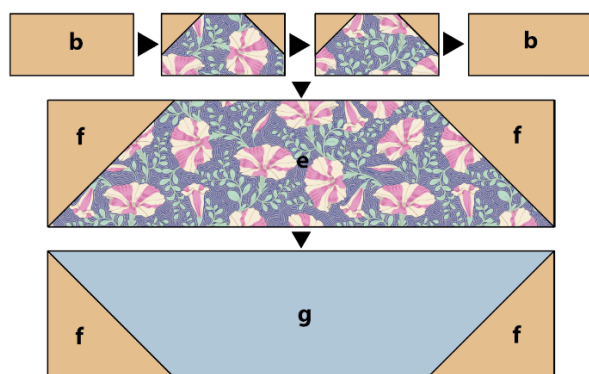

7 To make the body, sew the pieces together (**i/h/i**) as shown in **Fig F**. Now, using the same corner triangle technique add the **f** pieces – note that these triangles are formed over more than one fabric piece.

Fig F Making the body unit

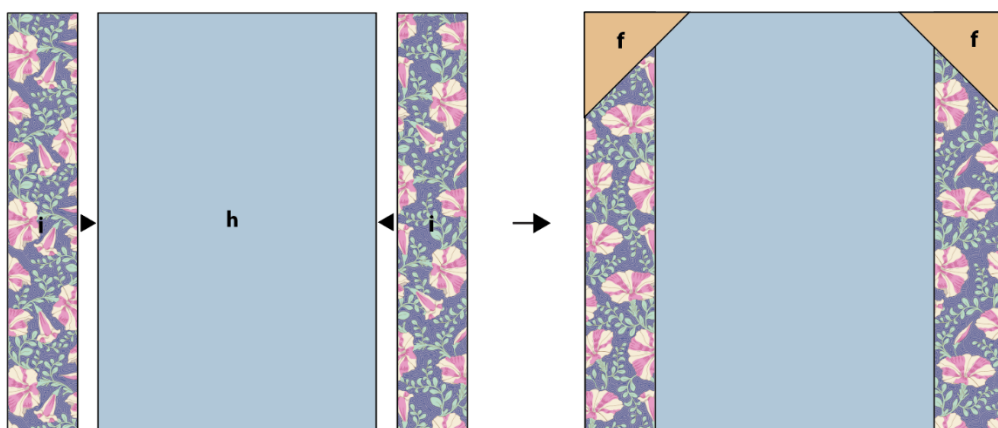

8 To make the legs, create corner triangles on the print square (**j**), using the background squares (**f**), positioning them as shown in **Fig G 1**. Add the rectangle (**a**) to the top. Make the other leg the same way but position the **f** squares as in **Fig G 2**.

Fig G Making the leg units

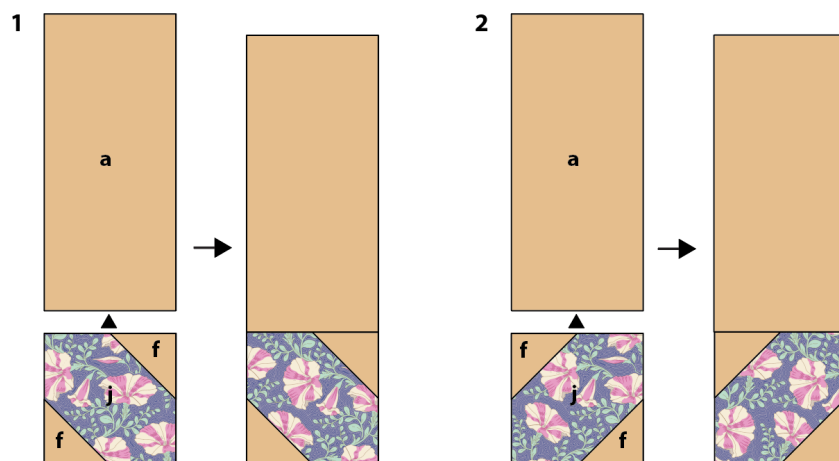

9 To assemble the block, take all the units you have made and sew them together, following the stages in **Fig H**. Once sewn, check the block is 12½in x 10¼in (31.8cm x 26cm).

Fig H Assembling the Frog block

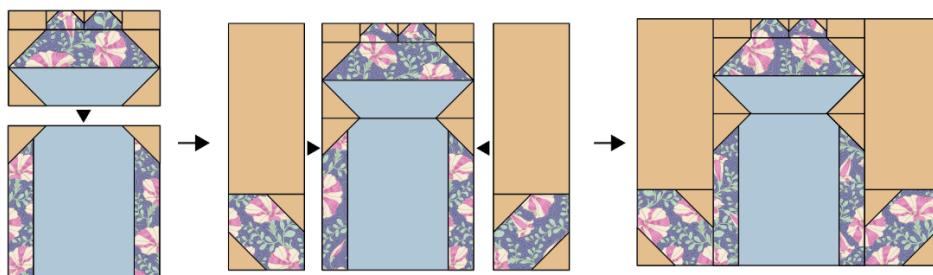

10 Make the other two Frog blocks, following **Fig B** to choose the correct fabrics.

Assembling the Pillow

11 When all of the blocks are made, sew them together in a row and press the seams. Add the Border A pieces to the top and bottom of the pillow and press seams outwards.

12 To finish the patchwork, embroider the eyes on the frogs (**Fig I**), using six strands of black stranded cotton and working French knots with the yarn wrapped twice around the needle.

Fig I Adding the eyes

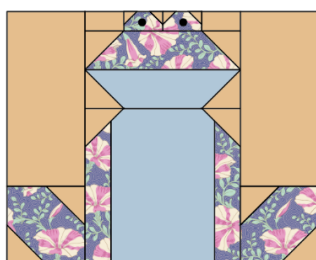

Quilting and Finishing

13 Make a quilt sandwich of the patchwork, wadding (batting) and lining fabric (if using). Quilt as desired. Trim off excess wadding and lining fabric to match the patchwork.

14 To make up the pillow cover, on both pieces of fabric for the pillow back, create a hem along one short side of each piece, by turning the edge over by 1 in (2.5cm), twice. Sew the seam with matching thread and press.

15 For the fastening, create four equally spaced buttonholes using your sewing machine within the hem of the right-hand piece (**Fig J**). Sew four buttons on the left-hand piece, matching their positions to the buttonholes. Note: Instead of buttons, you could use a hook and loop fastening, such as Velcro, if you prefer.

Fig J Making up with a button fastening

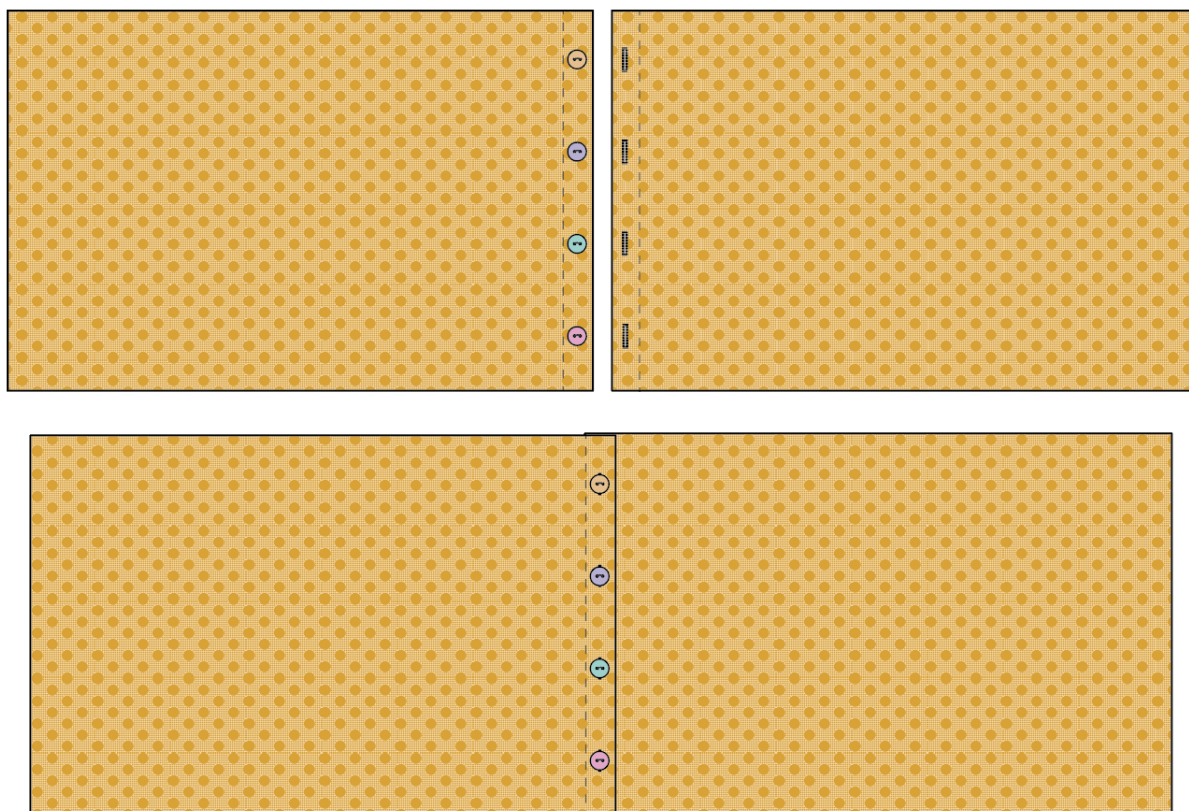

16 The pillow has a bound edge, so the pieces are assembled with right sides out, as follows. Place the quilted patchwork right side down. On the backing, fasten the buttons into the buttonholes and then place the whole piece on top of the patchwork, right side up. Check it is the same length as the patchwork, trimming if need be. Make sure the outer edges of all pieces are aligned. Pin the layers together and then bind as normal. As you sew the binding in place it will fix the other layers together. Press the cover and insert a pillow pad to finish.